

SUPERFÍCIES E ARQUITECTURA



Edifício do Povo, Shanghai . O seu perfil sugere o caracter do alfabeto chinês que significa "pessoas". Assim será o Edifício do Povo na Expo 2010, na China.

SUPERFÍCIES E ARQUITECTURA



SUPERFÍCIES E ARQUITECTURA



Museu Guggenheim em Abu Dhabi

architect Frank Gehry



SUPERFÍCIES E ARQUITECTURA



SUPERFÍCIES E ARQUITECTURA

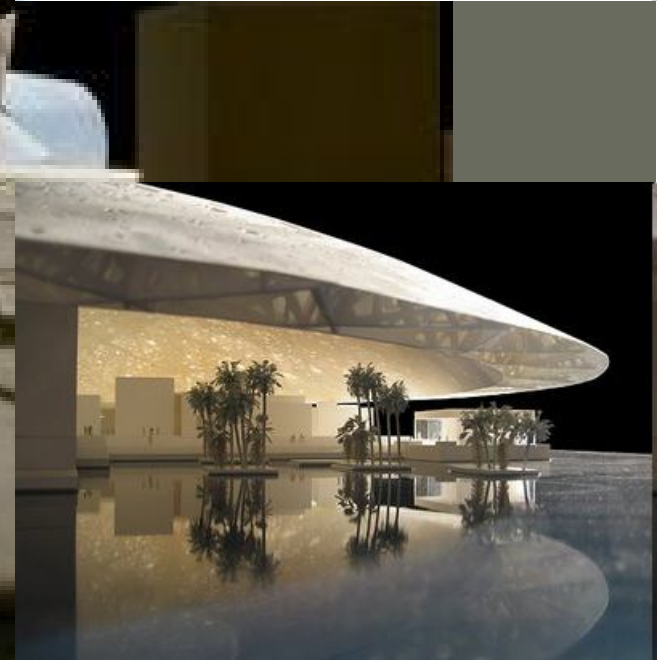

SUPERFÍCIES E ARQUITECTURA

Abu Dhabi Performing Arts Centre by Zaha Hadid



SUPERFÍCIES E ARQUITECTURA



SUPERFÍCIES E ARQUITECTURA

Formal Development

Formal Adoption and Selection

The basic list of simple geometries is being superimposed with programmatic diagrams and architectural interpretations of the main theme in a series of iteration cycles, subsequently transferring the underlying typologies from abstract diagrams to an architectural design sketch.



Differentiation and Specialization

Basic components of the underlying biological analogy, stems, branches, leaves, veins, fruits, are translated into components of a building, giving a more resolved display of structural support, infrastructure connections, enclosed bodies and circulation spaces.



Interpretation and Refinement

The developed sculptural sketch is being refined, re-translated and aligned to the urban context. Secondary elements like facade structures and details are added according to the language developed.

SUPERFÍCIES E ARQUITECTURA

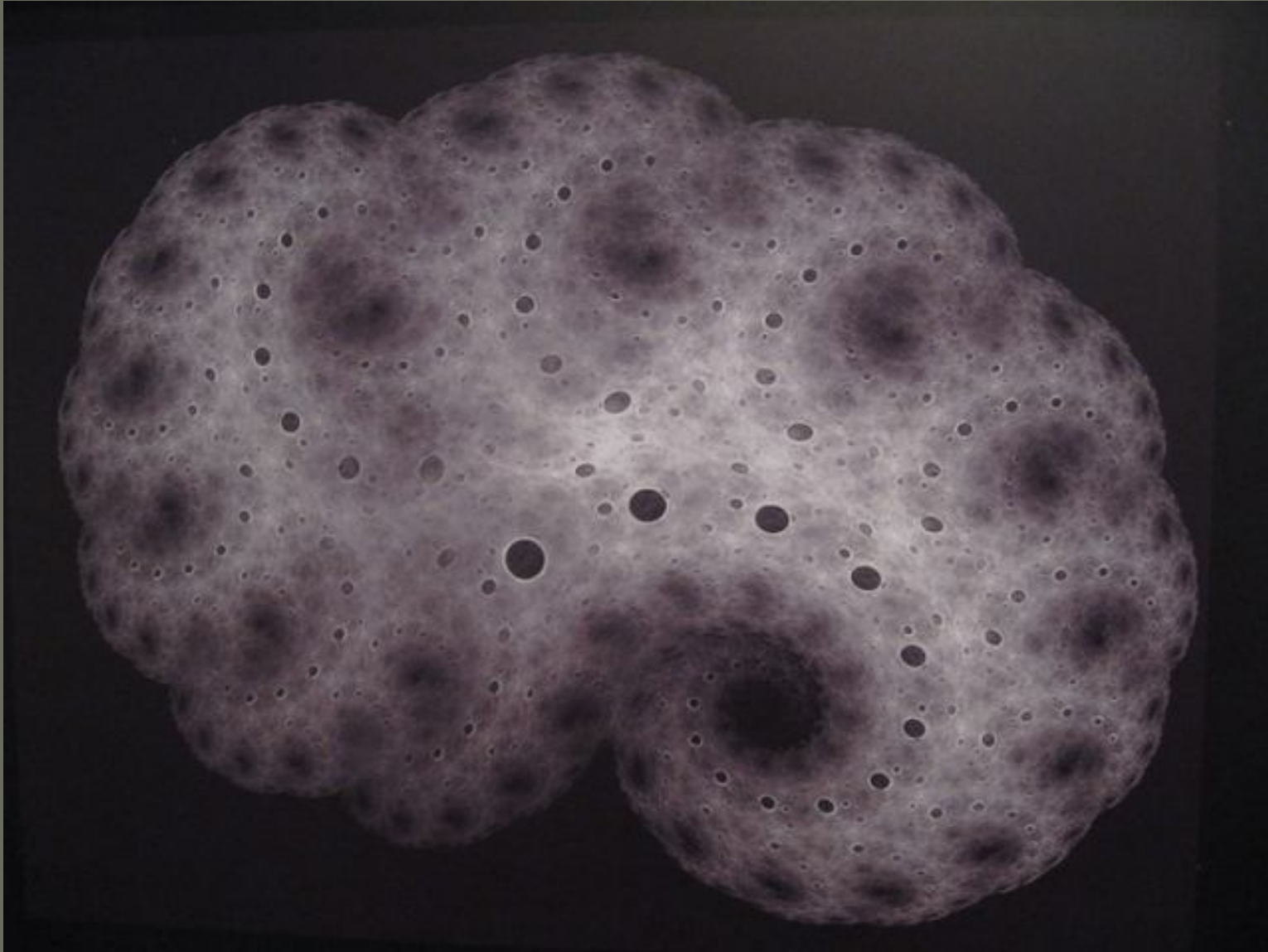

SUPERFÍCIES E ARQUITECTURA



SUPERFÍCIES E ARQUITECTURA



SUPERFÍCIES E ARQUITECTURA



SUPERFÍCIES E ARQUITECTURA



SUPERFÍCIES E ARQUITECTURA

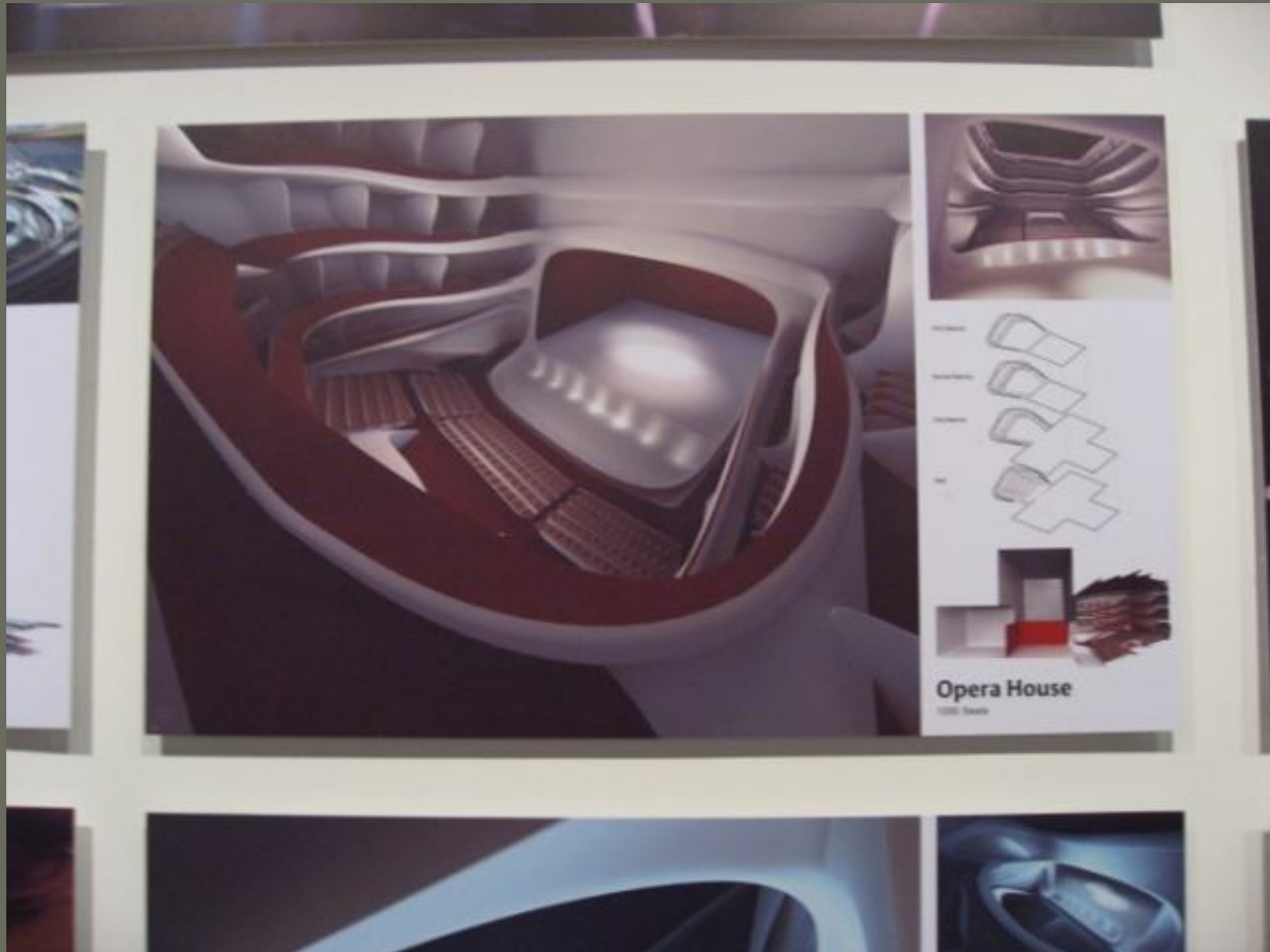

SUPERFÍCIES E ARQUITECTURA

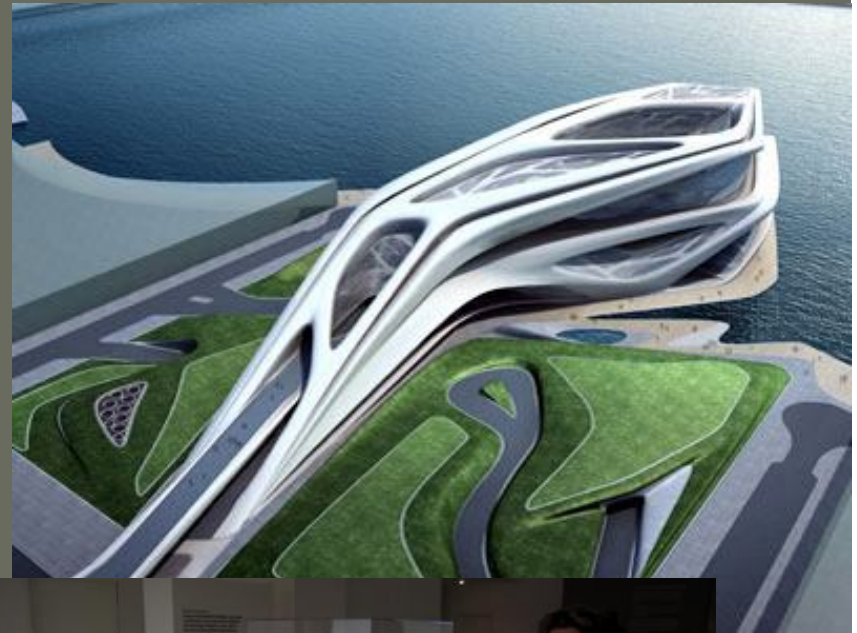
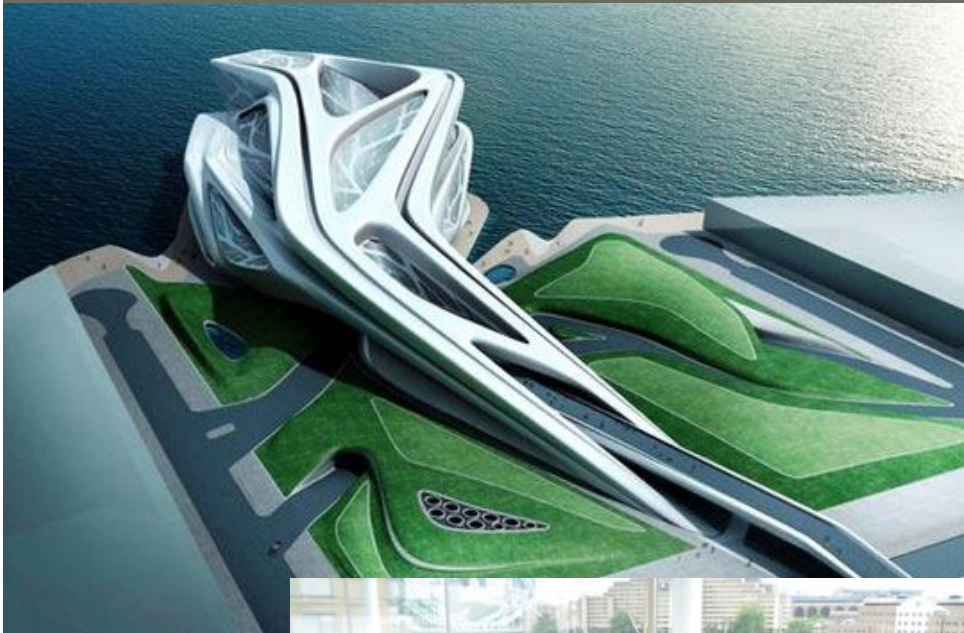

SUPERFÍCIES E ARQUITECTURA

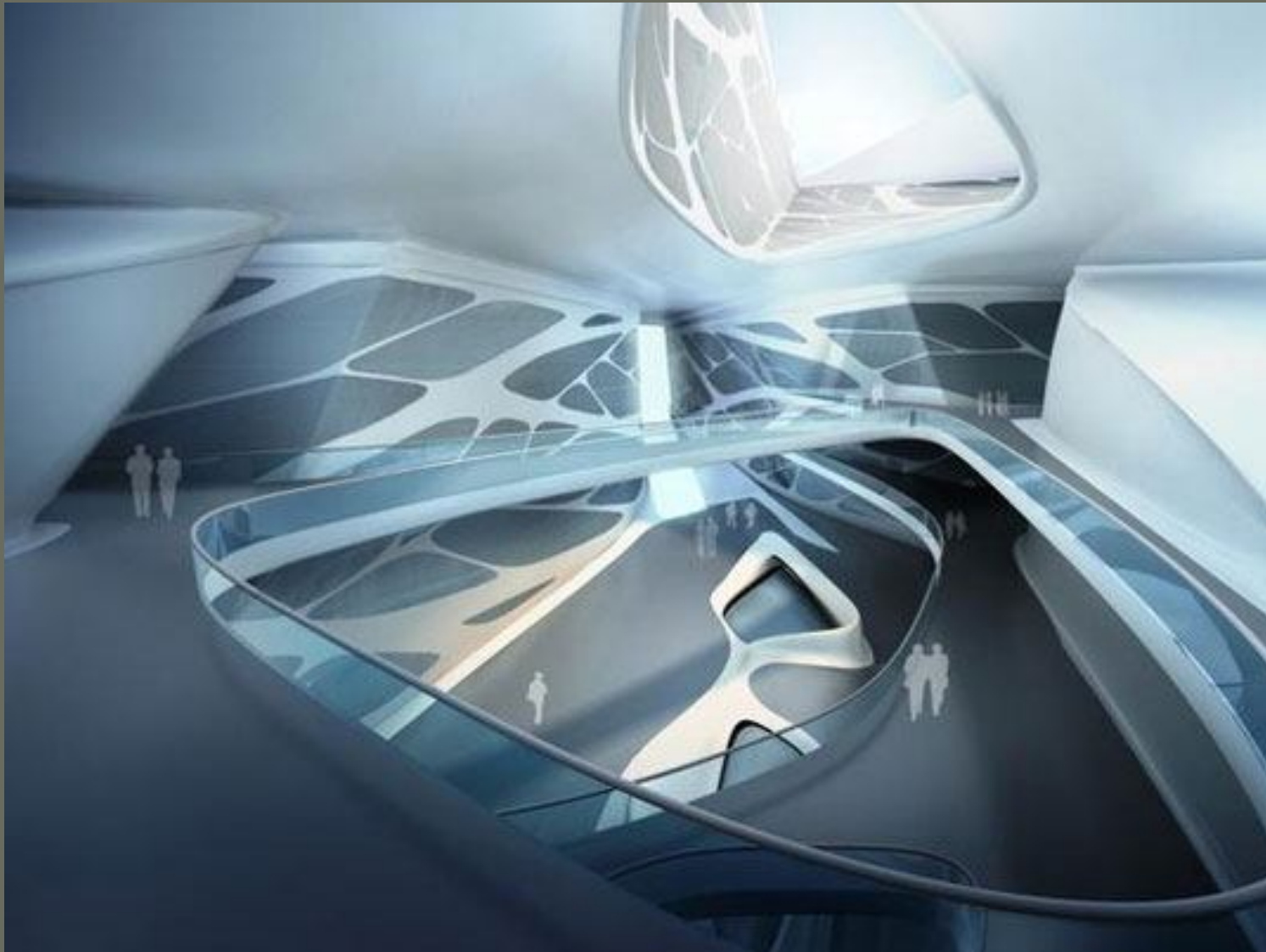

SUPERFÍCIES E ARQUITECTURA

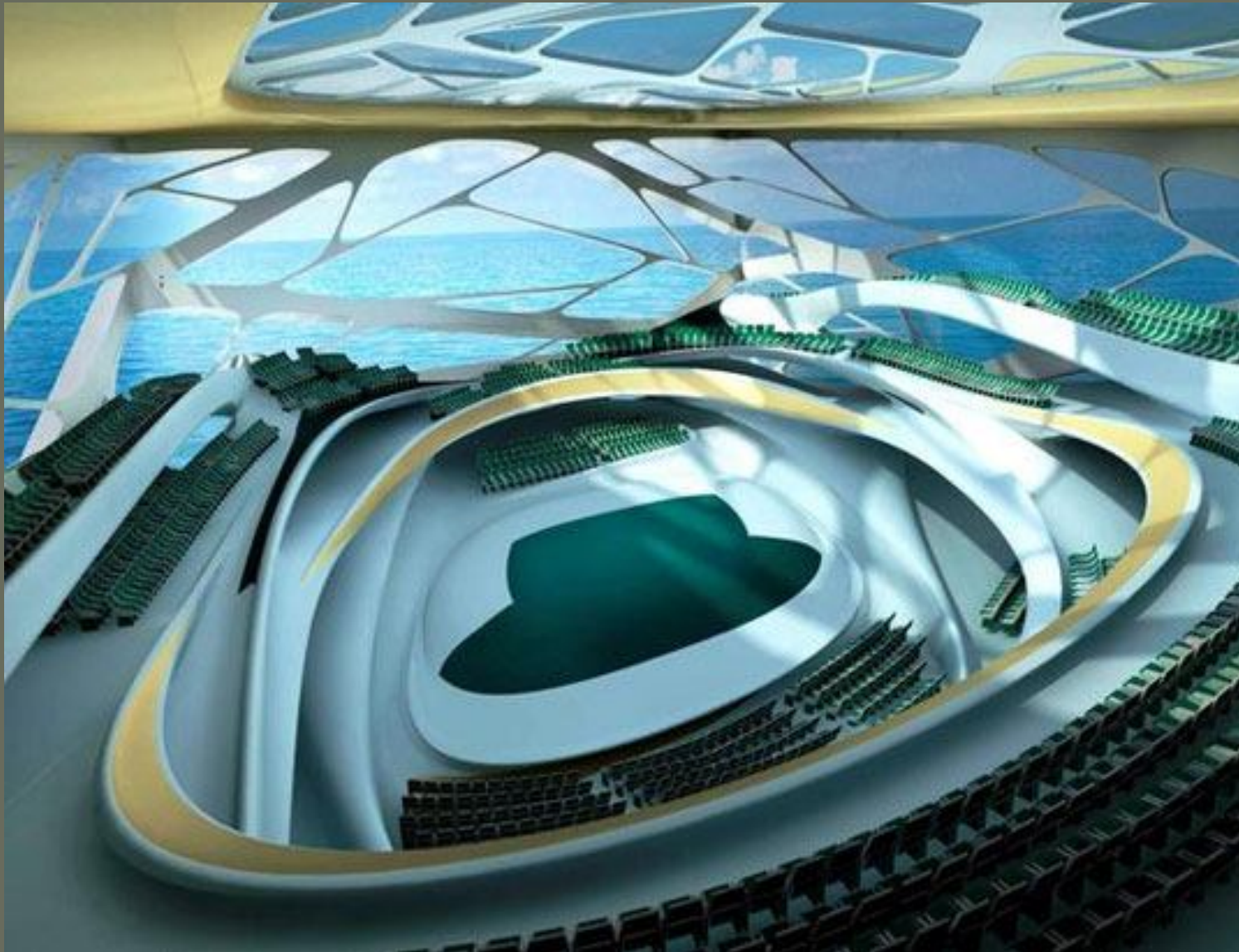

SUPERFÍCIES E ARQUITECTURA

Zaha Hadid Architects, Cairo Expo City, Cairo, Egypt

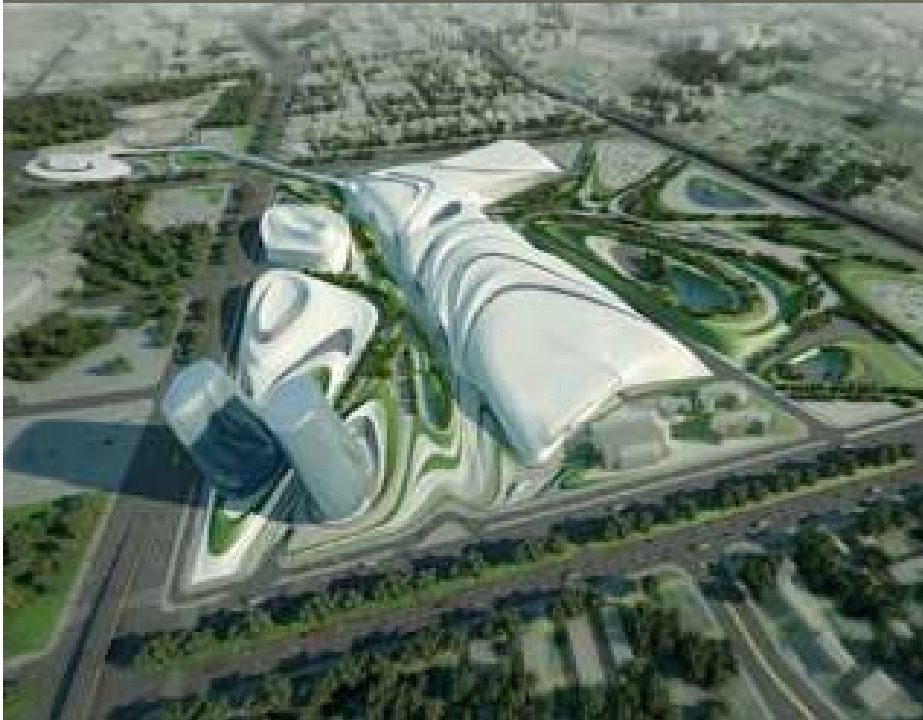

Construction start: 2009

SUPERFÍCIES E ARQUITECTURA



SUPERFÍCIES E ARQUITECTURA

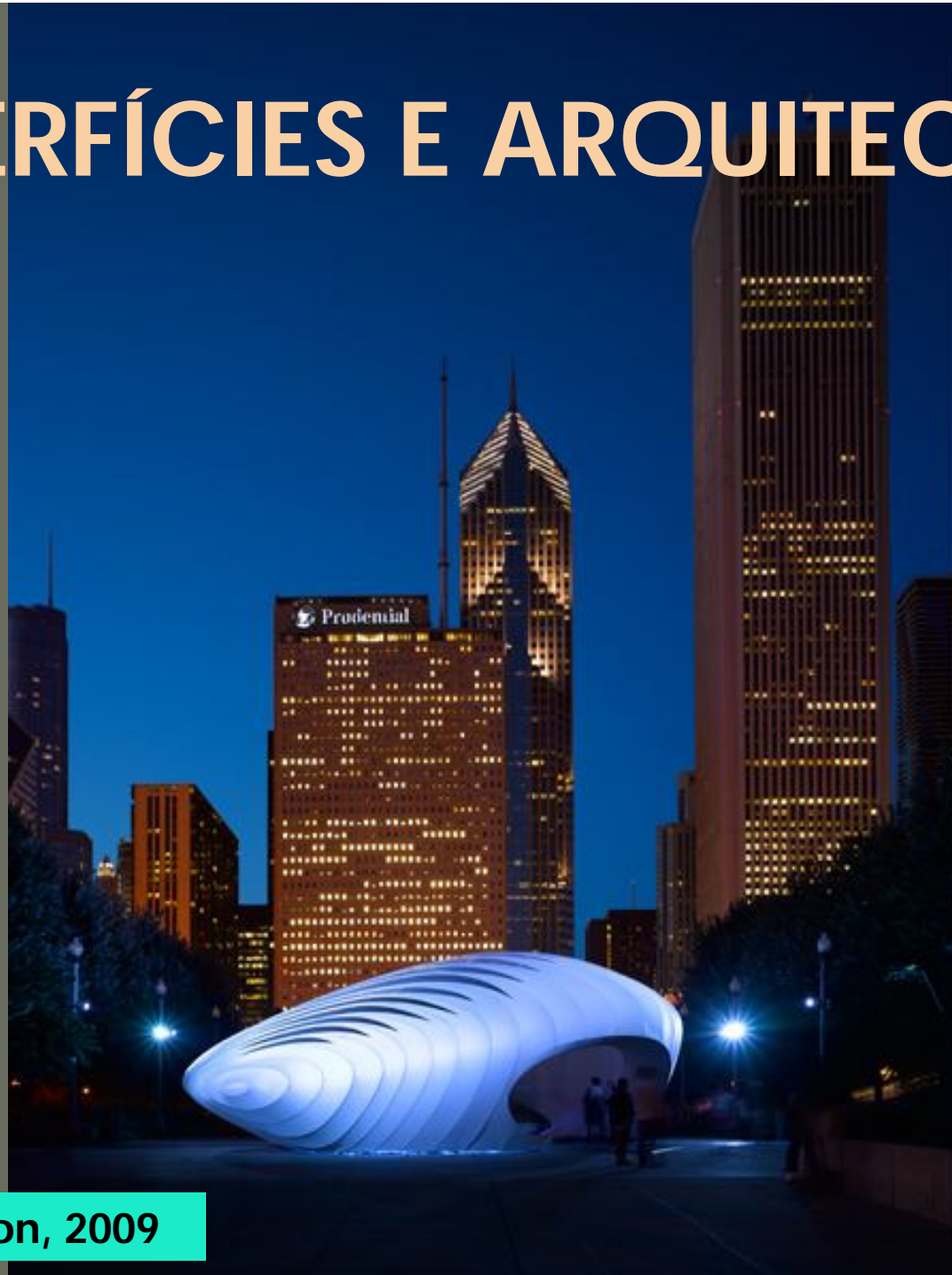

Burnham Pavilion, 2009

SUPERFÍCIES E ARQUITECTURA



[Evelyn Grace Academy](#), London, UK, 2006–2010

SUPERFÍCIES E ARQUITECTURA



Sunrise Tower - Kuala Lumpur, Malaysia- 2009

SUPERFÍCIES E ARQUITECTURA

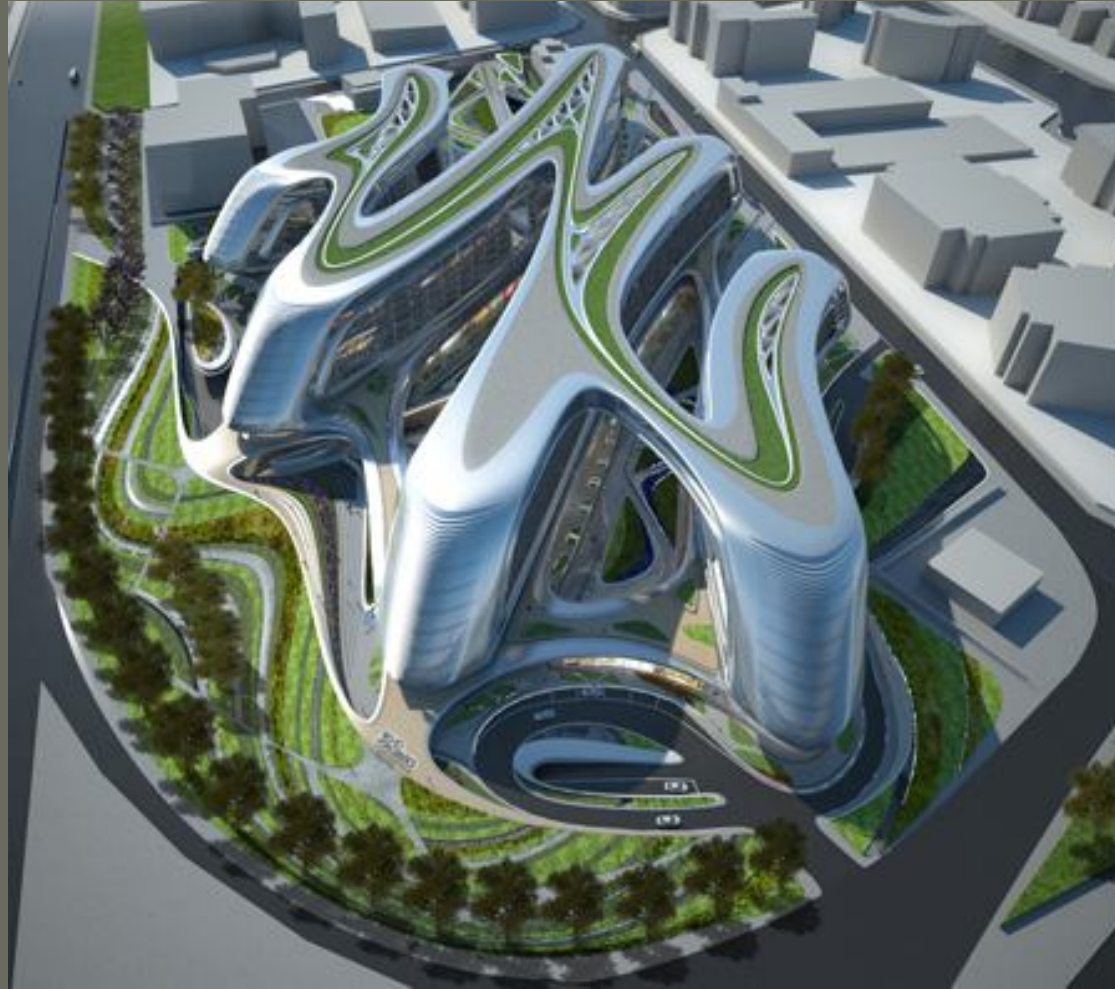

[Hongqiao Soho](#) - Shanghai, China, 2010-TBC

SUPERFÍCIES E ARQUITECTURA

Abu Dhabi | UAE | Hotel | Asymptote Architecture

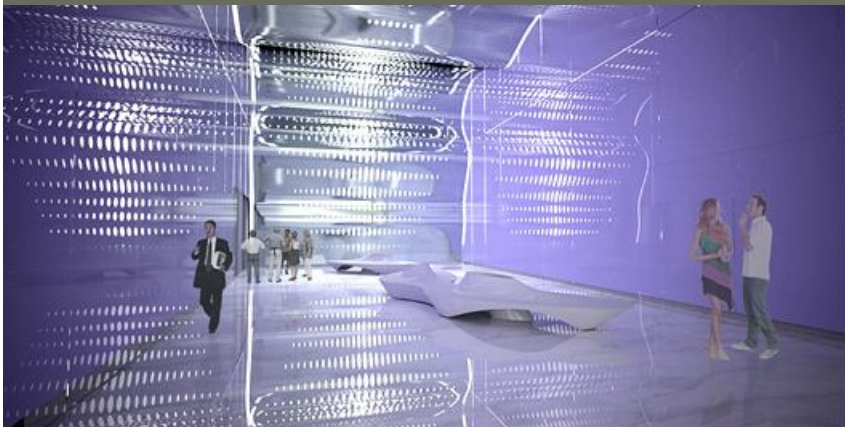

SUPERFÍCIES E ARQUITECTURA



Abu Dhabi - Schumacher Tower- Arquitetura por LAVA (architects)

SUPERFÍCIES E ARQUITECTURA

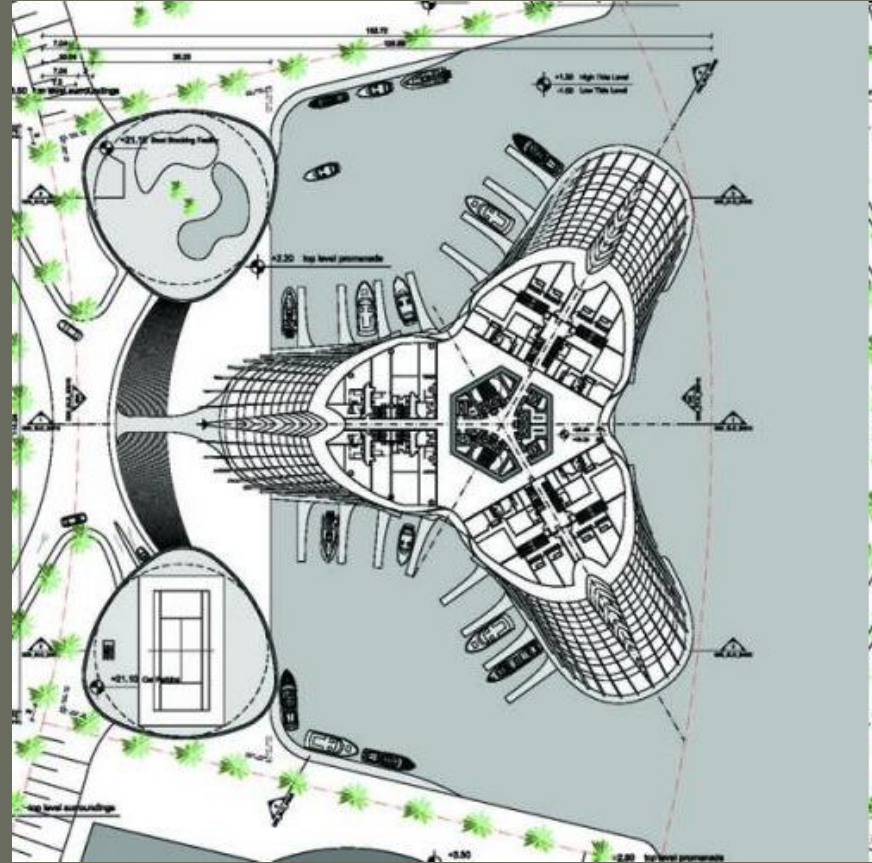
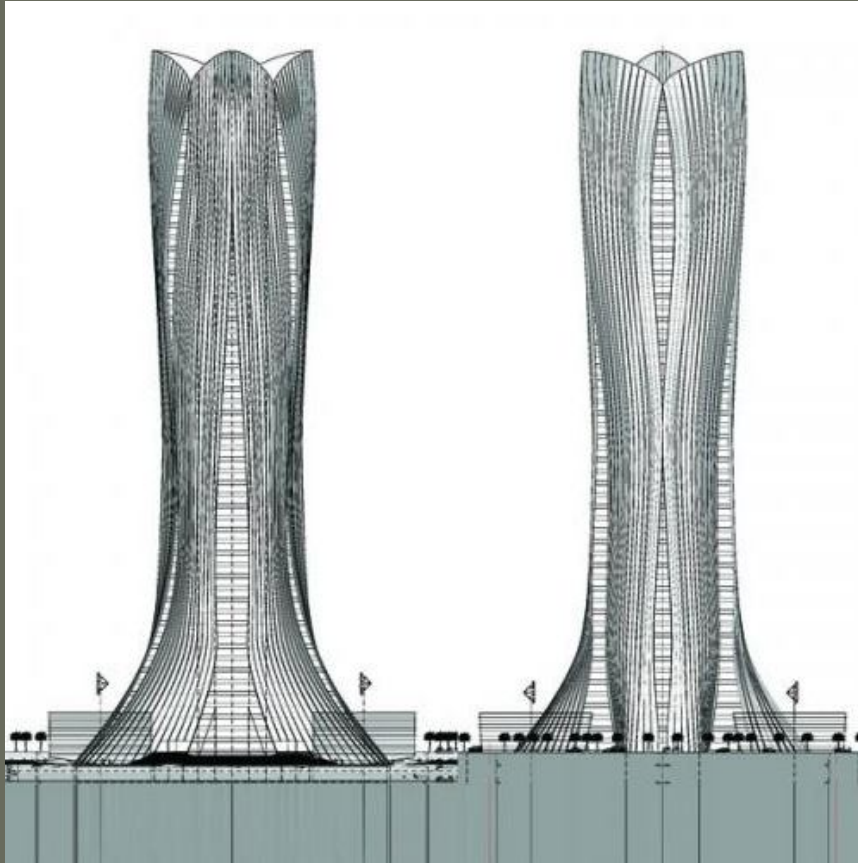

SUPERFÍCIES E ARQUITECTURA

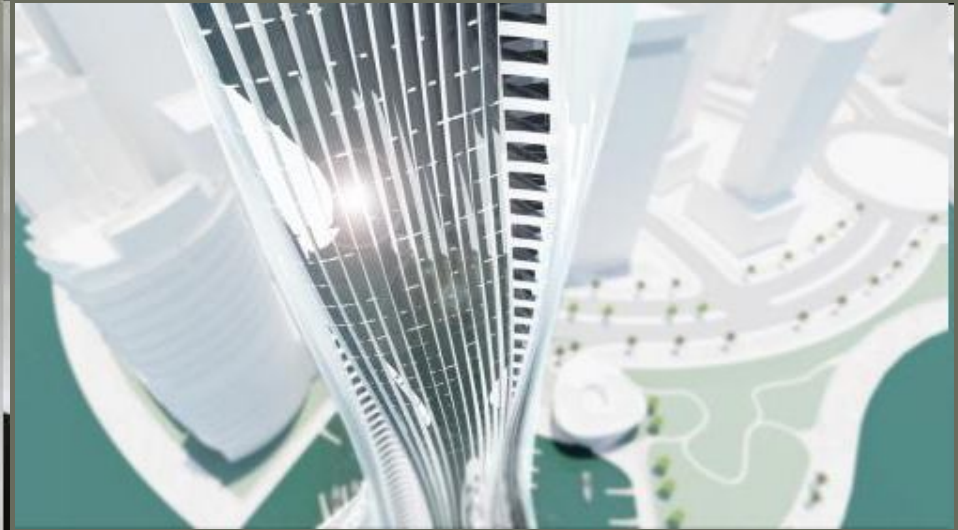

SUPERFÍCIES E ARQUITECTURA

Zaha Hadid Architects, Nordpark Cable Railway, Innsbruck, Austria, 2007



SUPERFÍCIES E ARQUITECTURA

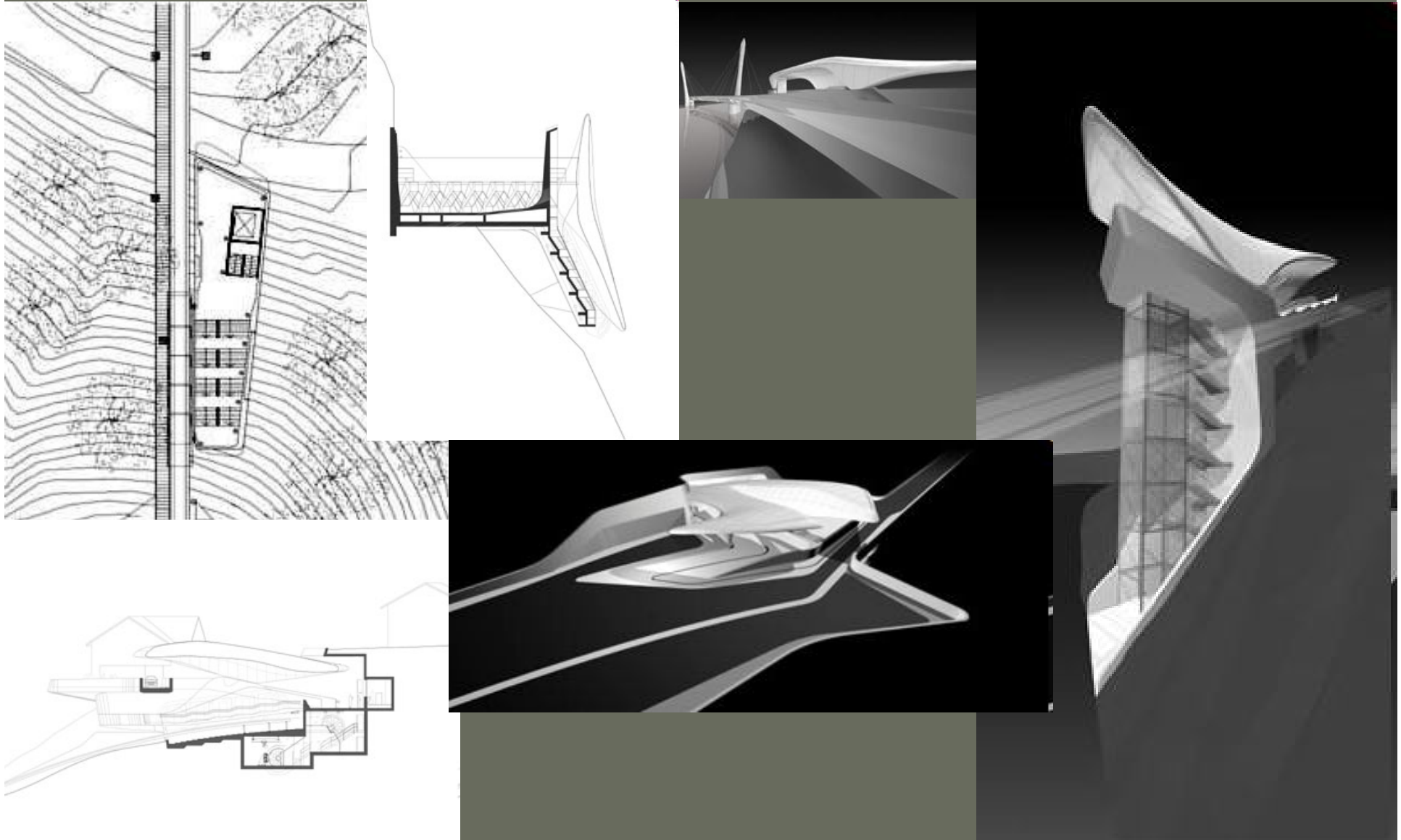

SUPERFÍCIES E ARQUITECTURA



SUPERFÍCIES E ARQUITECTURA



SUPERFÍCIES E ARQUITECTURA

Louvre Abu Dhabi



SUPERFÍCIES E ARQUITECTURA

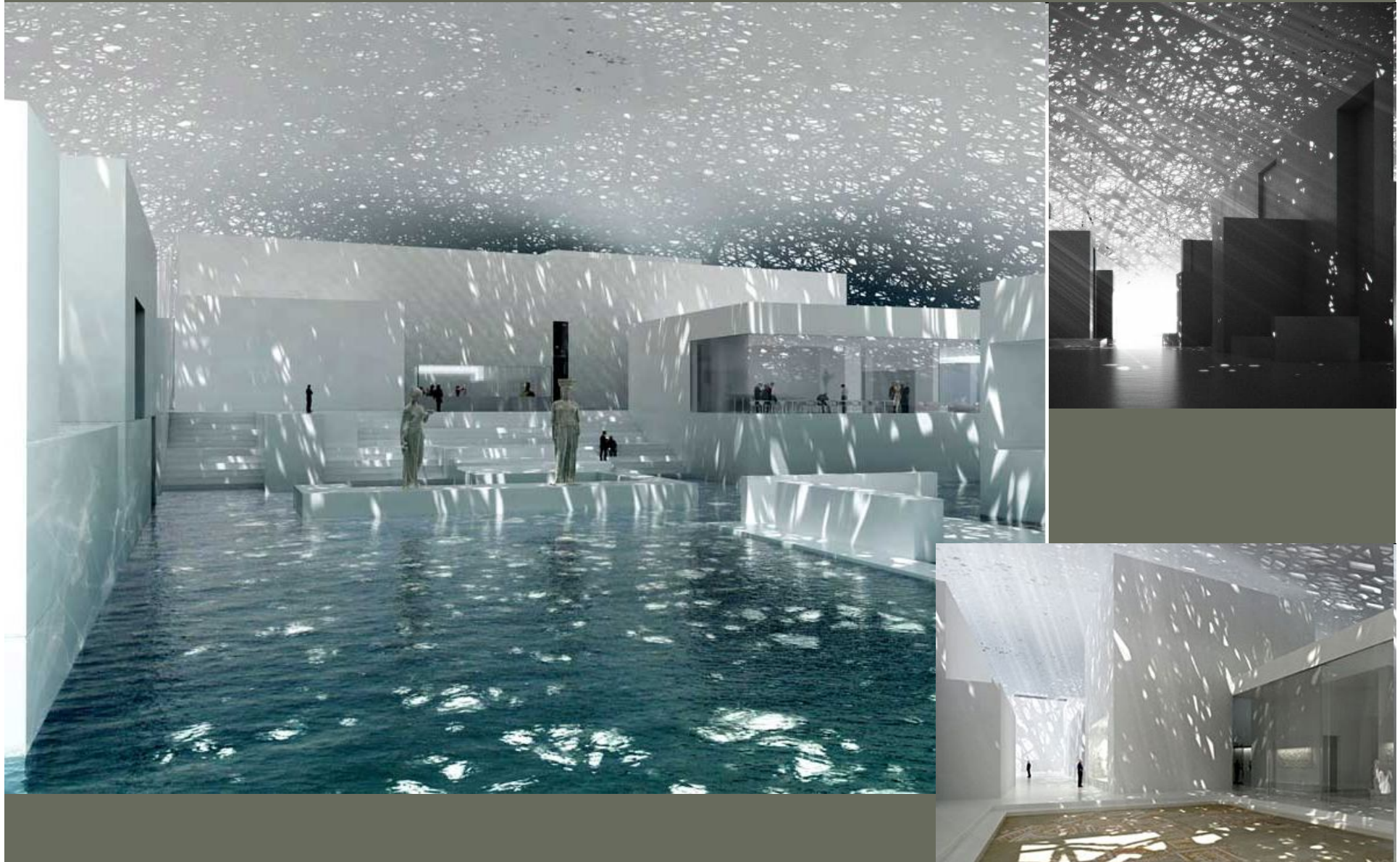

SUPERFÍCIES E ARQUITECTURA

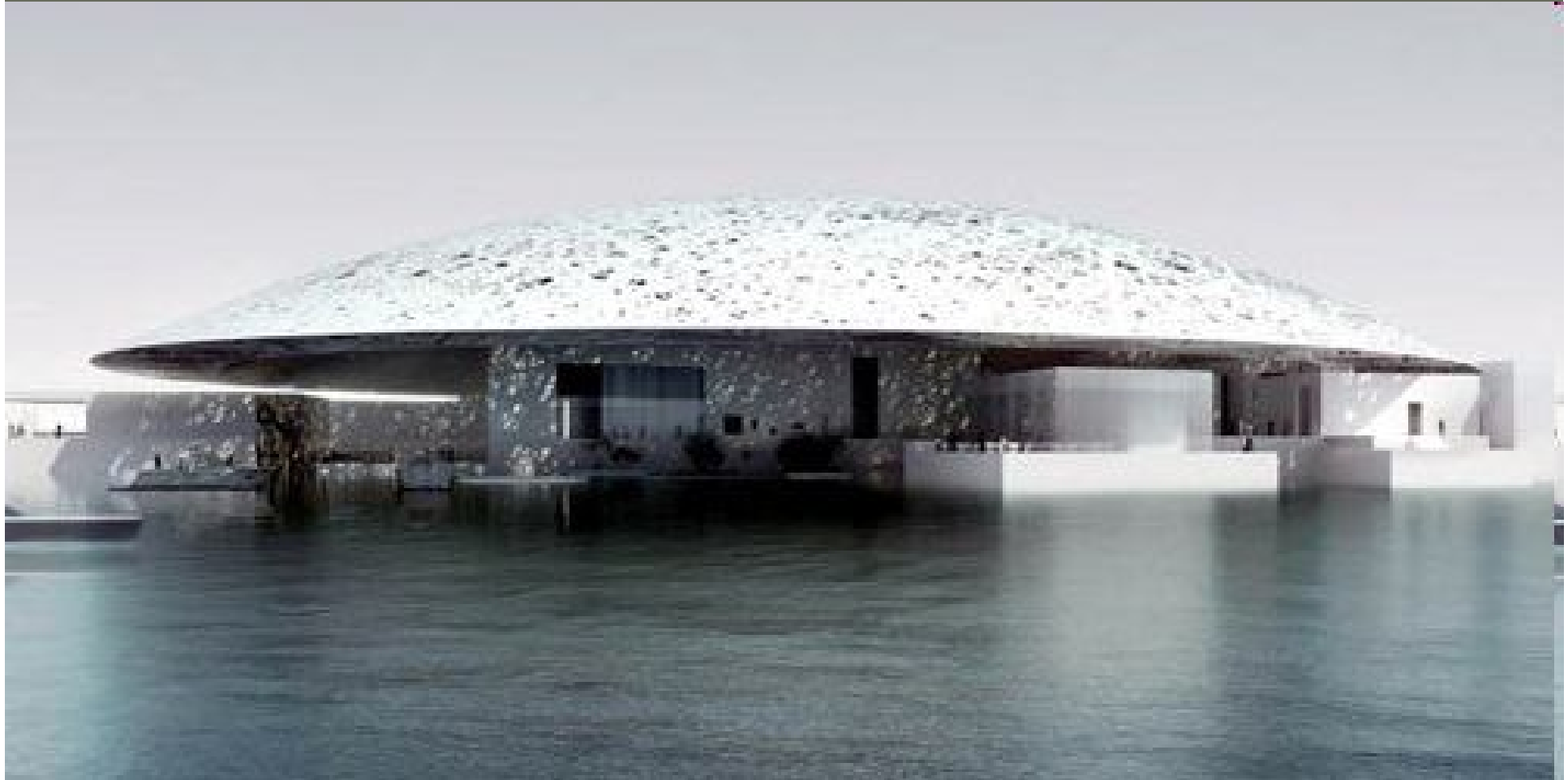

Jean Nouvel

SUPERFÍCIES E ARQUITECTURA



SUPERFÍCIES E ARQUITECTURA



SUPERFÍCIES E ARQUITECTURA



SUPERFÍCIES E ARQUITECTURA

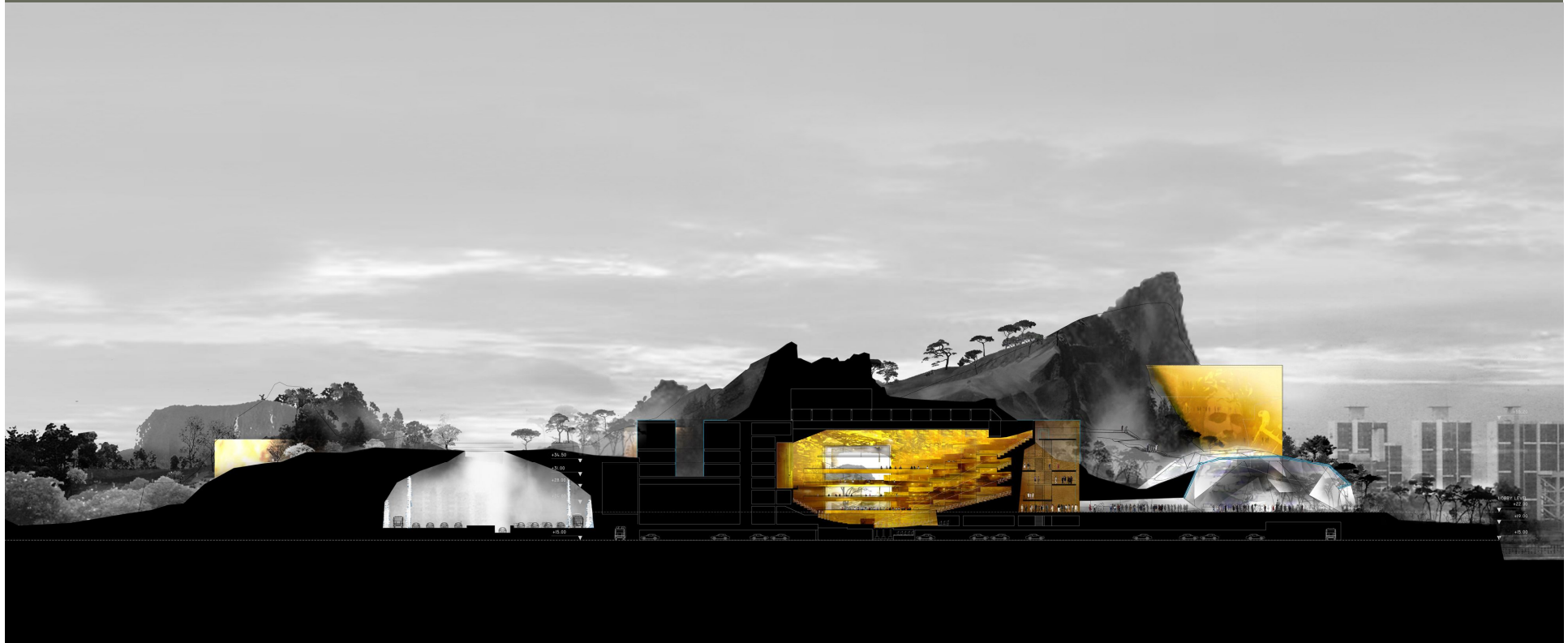

Ópera de Seoul – Coreia - 2006

SUPERFÍCIES E ARQUITECTURA

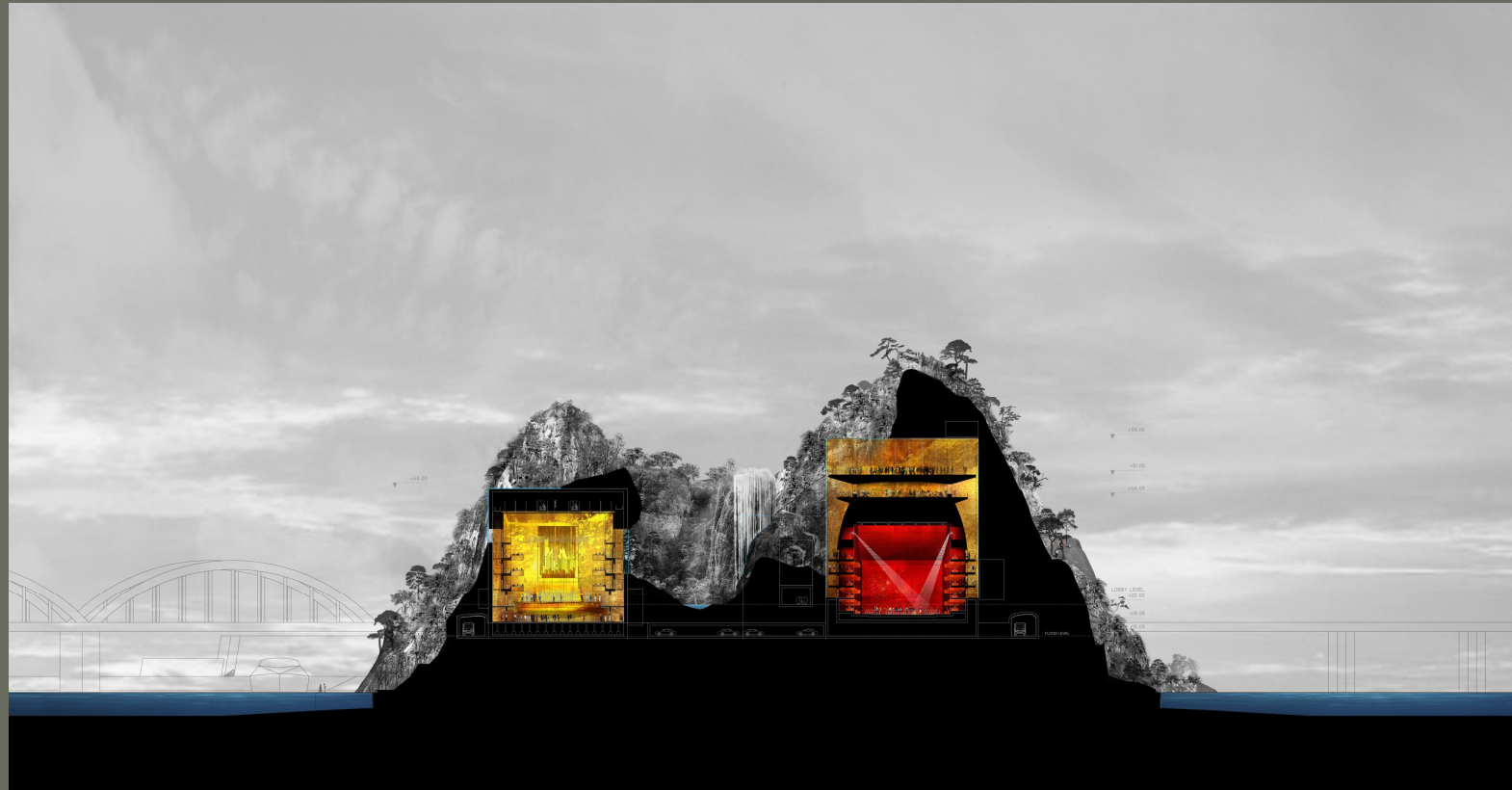

SUPERFÍCIES E ARQUITECTURA



SUPERFÍCIES E ARQUITECTURA



SUPERFÍCIES E ARQUITECTURA

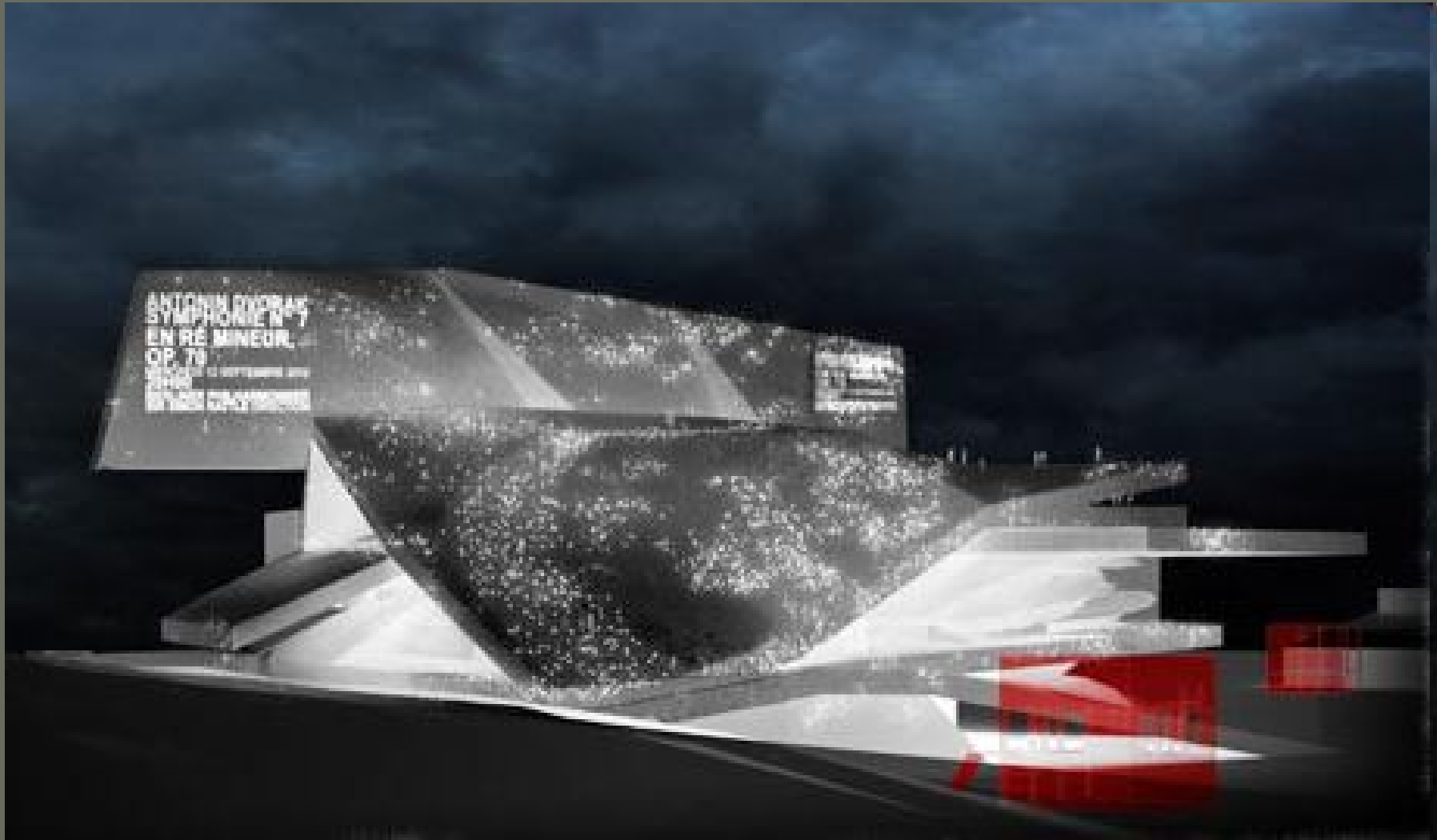

la philharmonie de paris', paris, france, 2007

SUPERFÍCIES E ARQUITECTURA

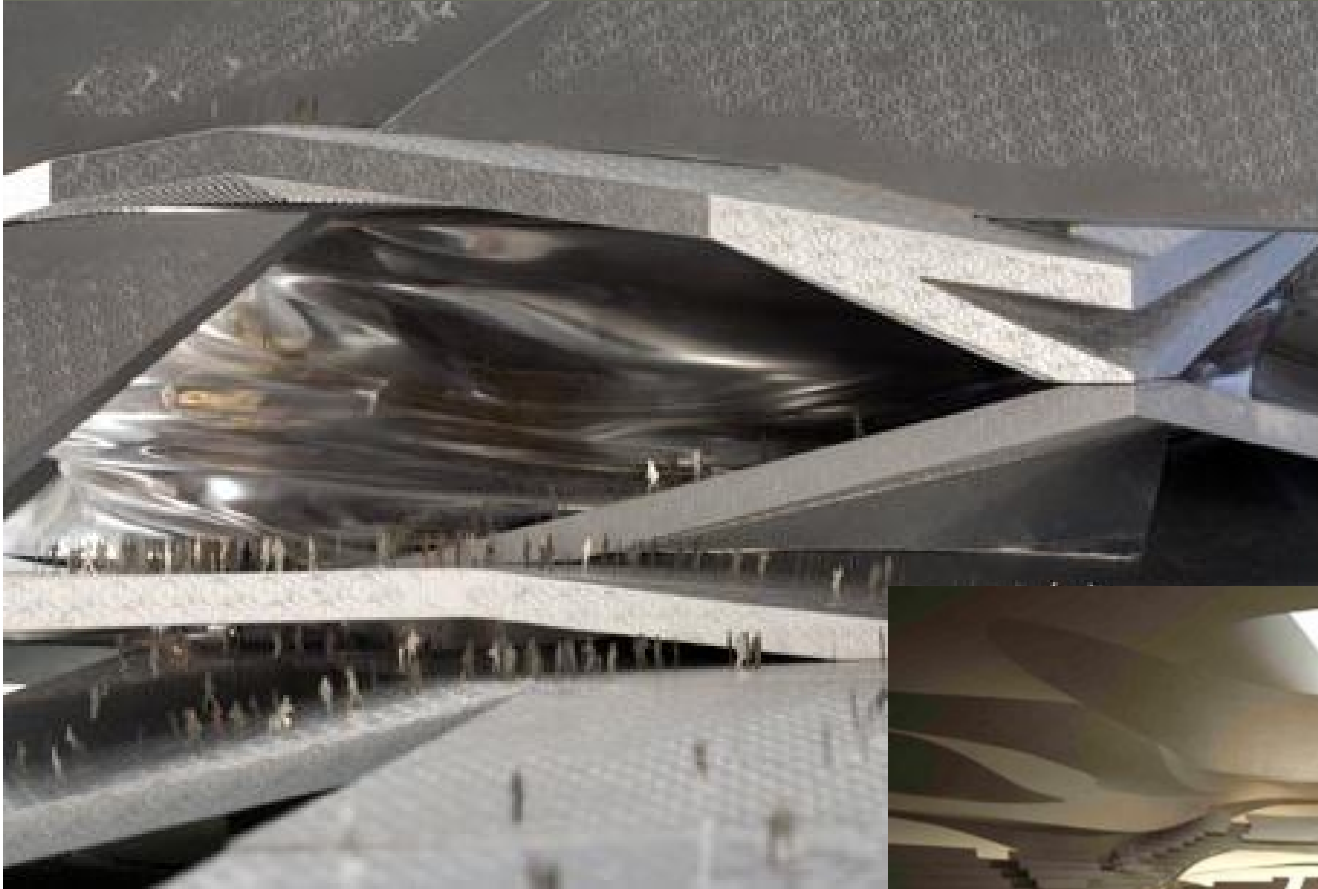

SUPERFÍCIES E ARQUITECTURA



Asymptote Architecture - Penang Global City Center - Malásia

SUPERFÍCIES E ARQUITECTURA

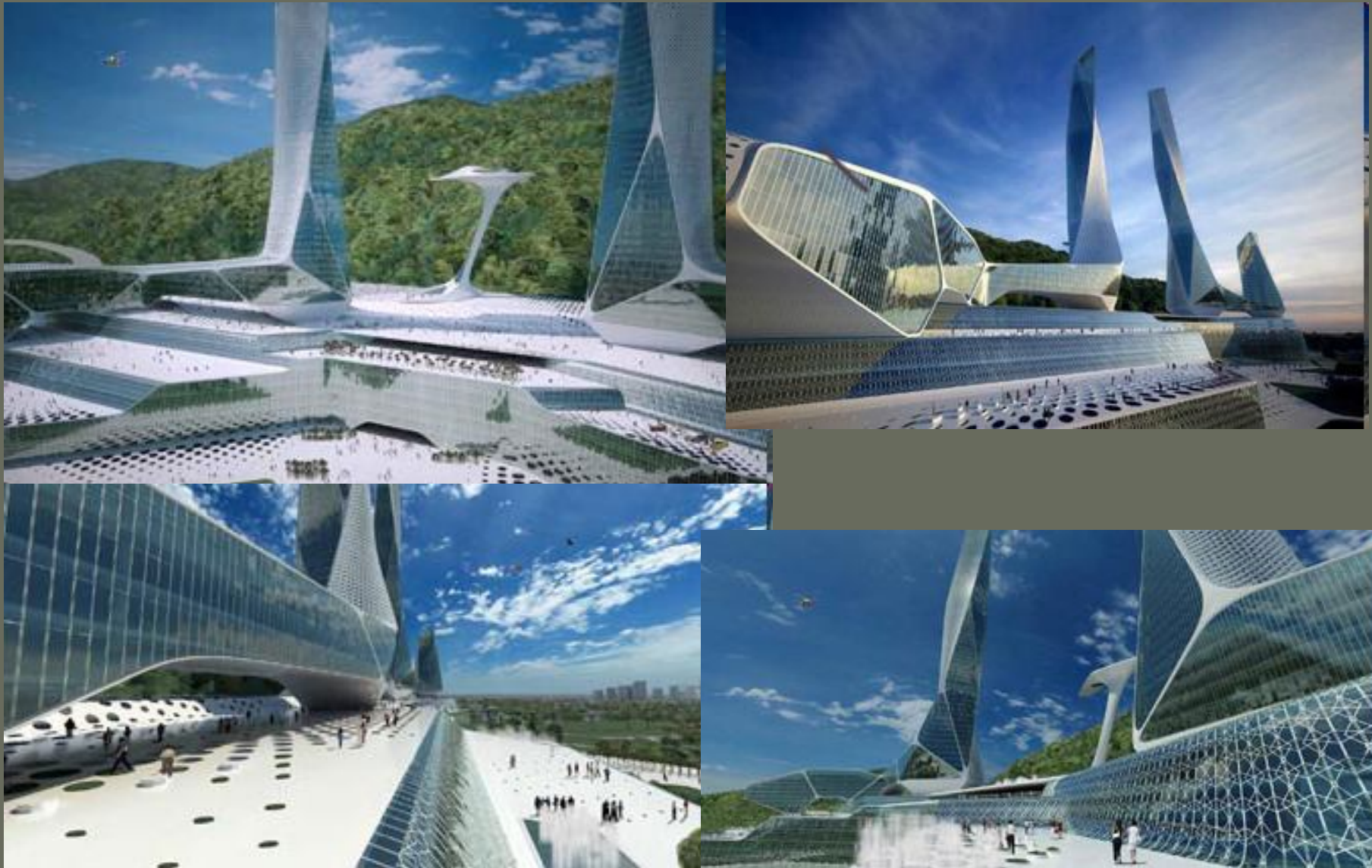

<http://www.arcspace.com/architects/asymptote/penang/penang.html>

SUPERFÍCIES E ARQUITECTURA



SUPERFÍCIES E ARQUITECTURA

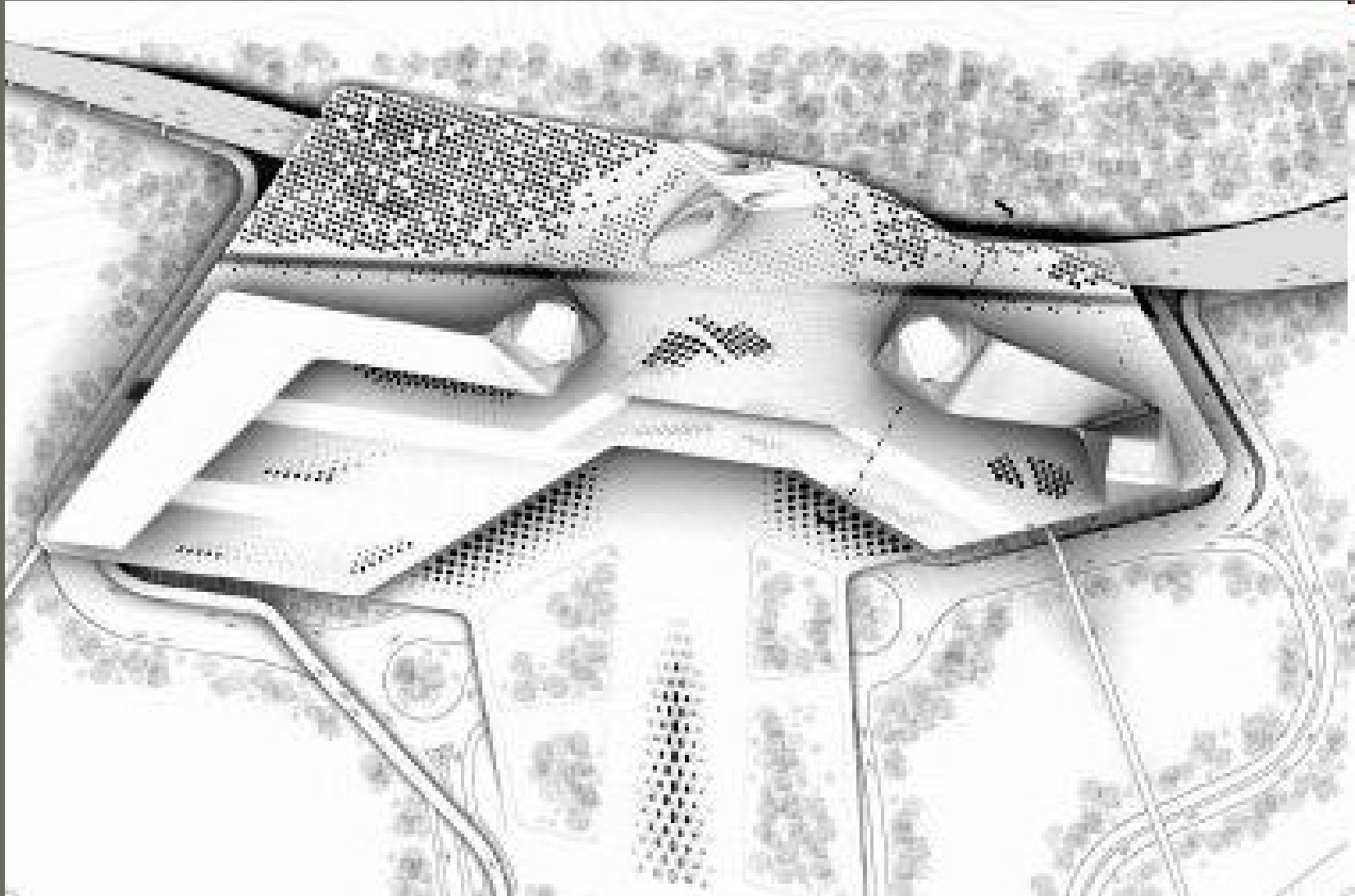

SUPERFÍCIES E ARQUITECTURA

Asymptote Strata Tower Abu Dhabi, UAE



SUPERFÍCIES E ARQUITECTURA

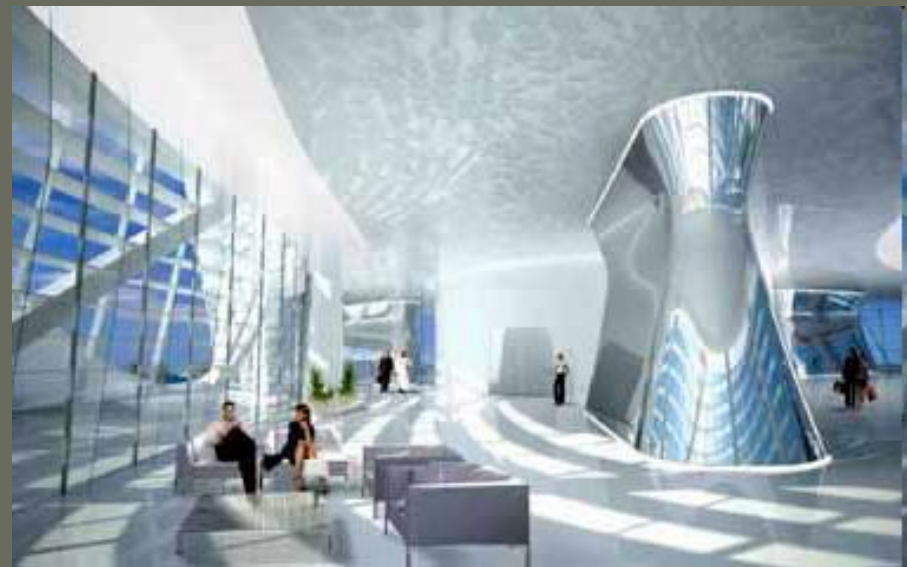

SUPERFÍCIES E ARQUITECTURA

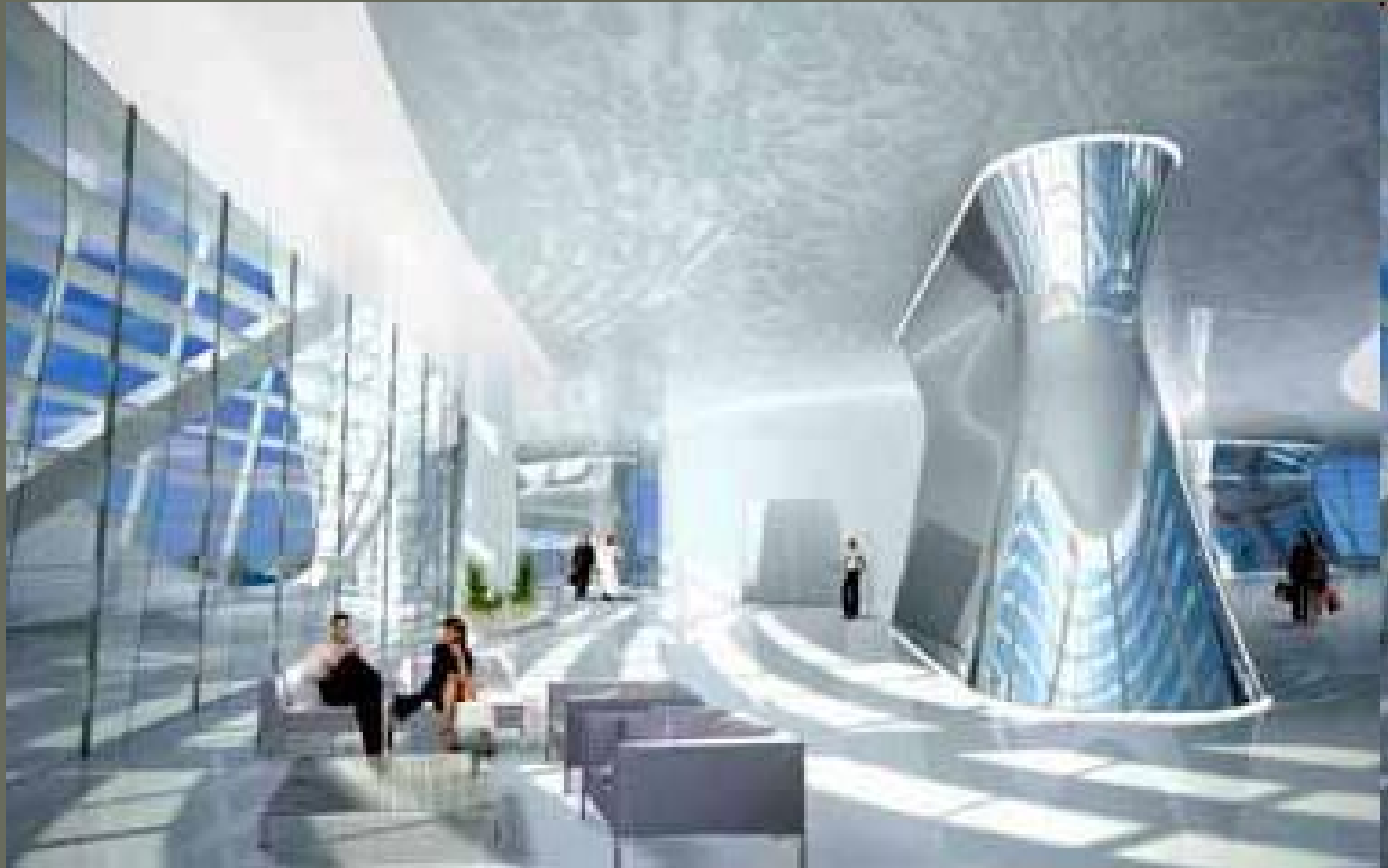

SUPERFÍCIES E ARQUITECTURA

Asymptote, BMW Event and Delivery Center, Munich, Germany

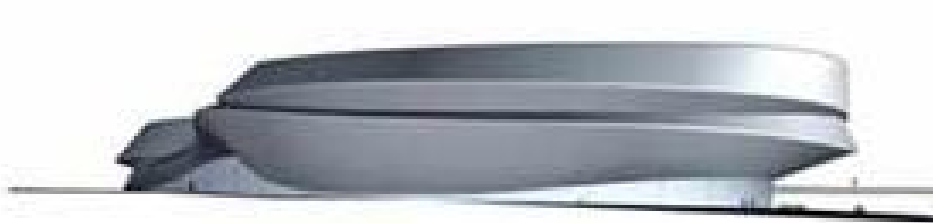

http://www.arcspace.com/architects/asymptote/bmw_index.html



SUPERFÍCIES E ARQUITECTURA

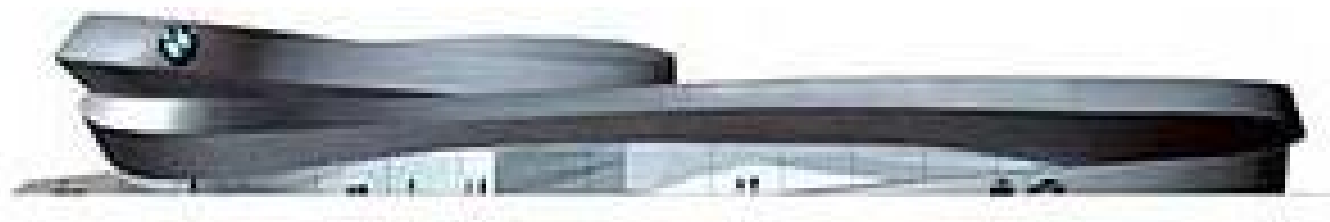
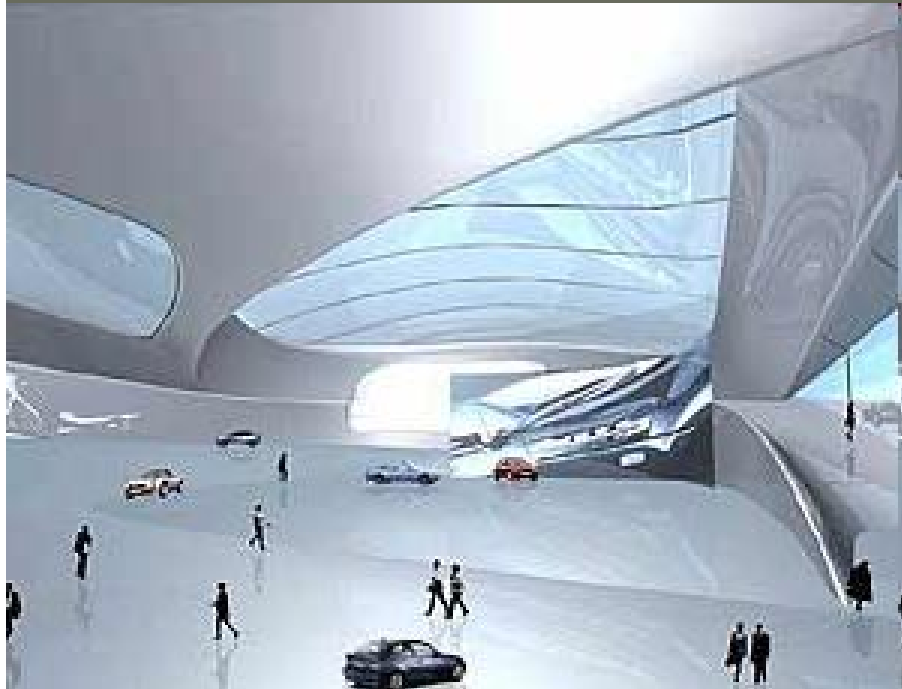

SUPERFÍCIES E ARQUITECTURA

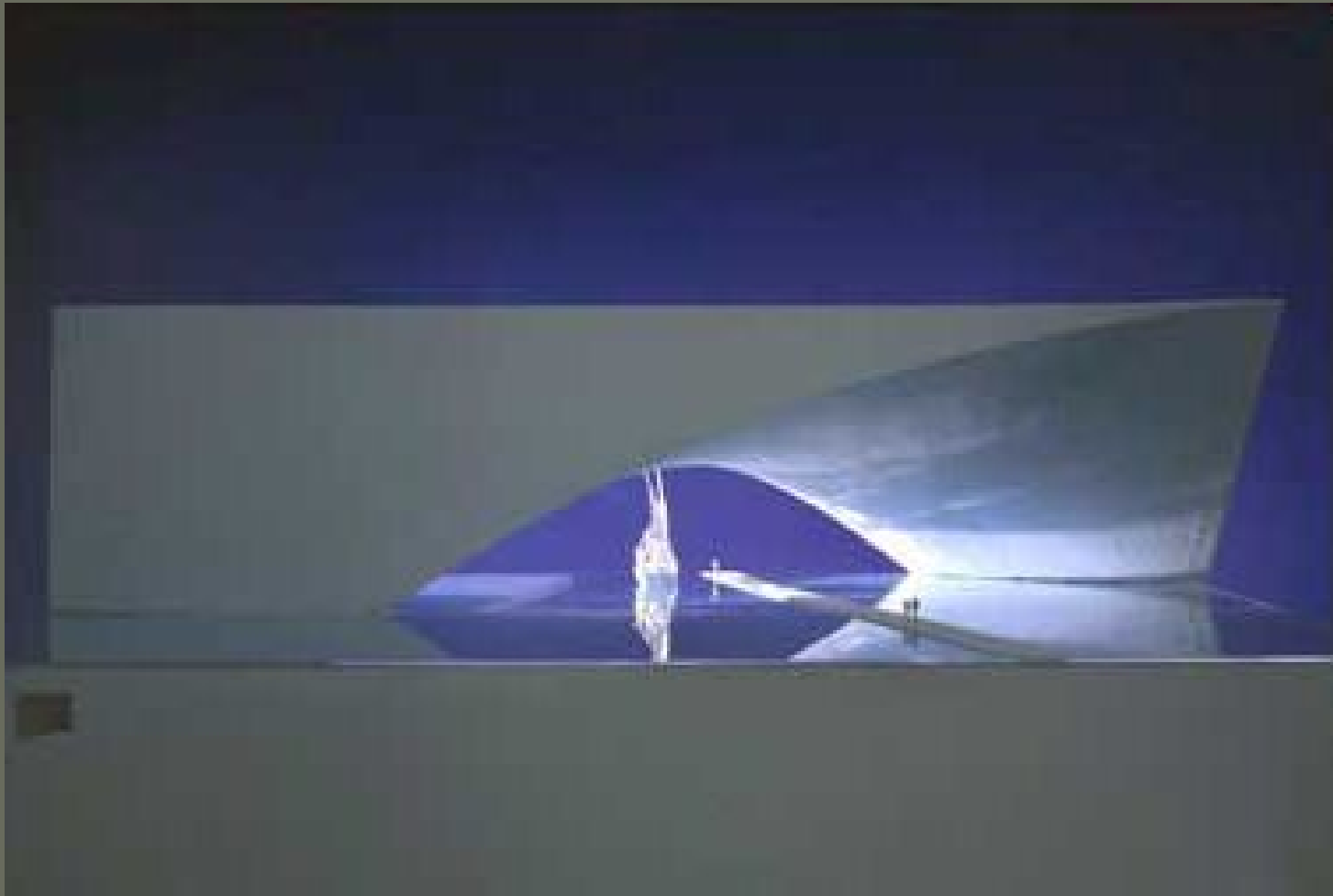

Tadao Ando

SUPERFÍCIES E ARQUITECTURA

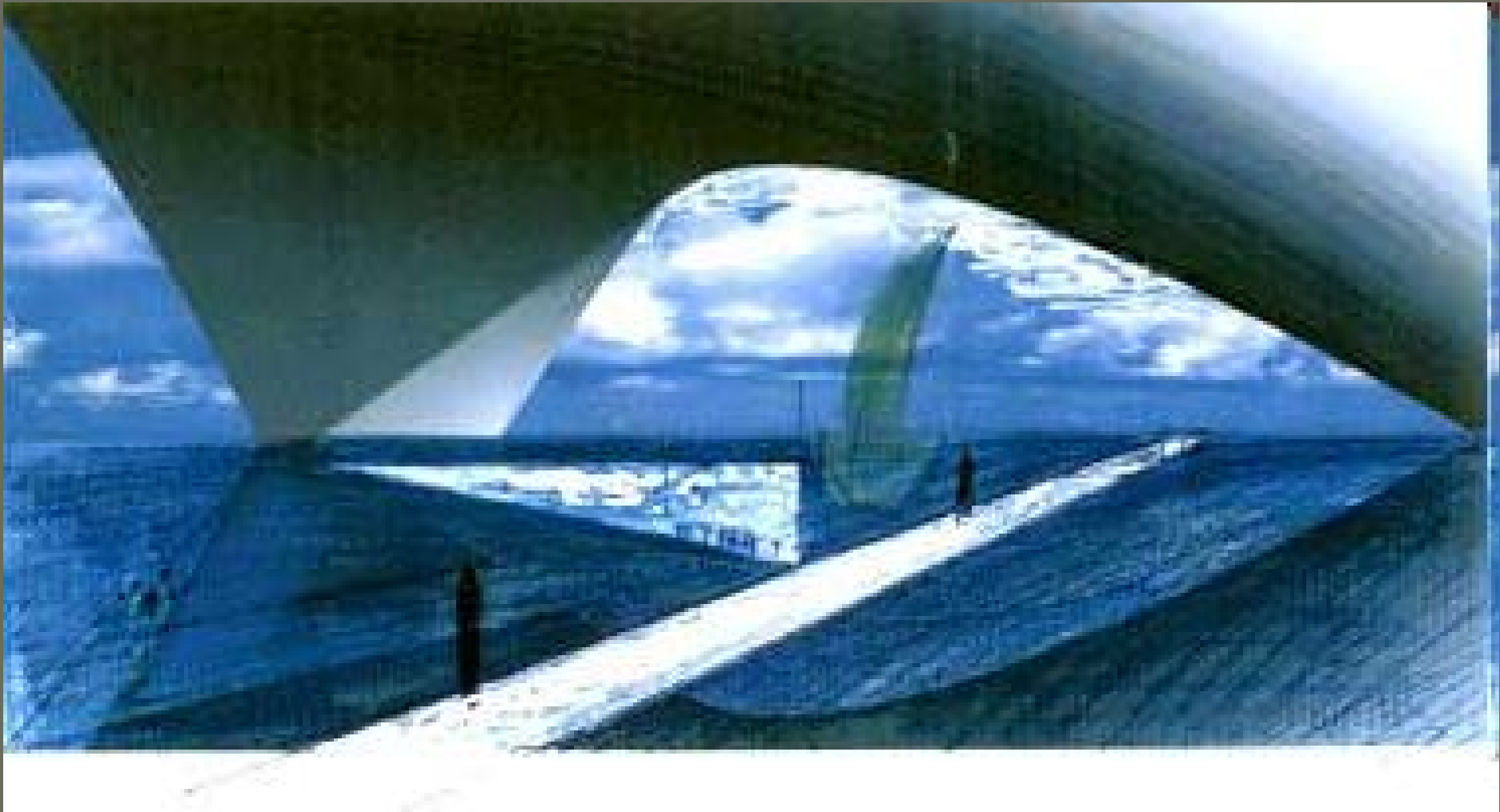

Ando's Maritime Museum

SUPERFÍCIES E ARQUITECTURA

Santiago Calatrava, Turning Torso. Malmö, Suécia

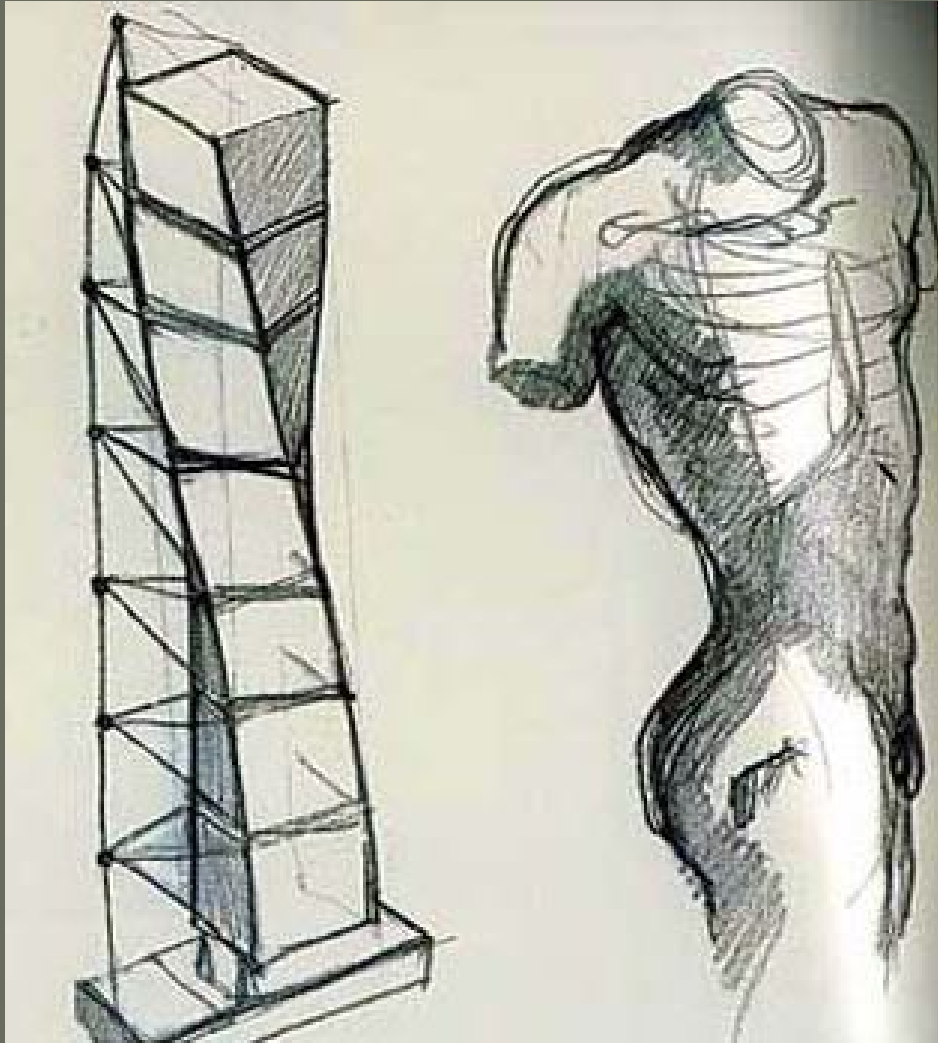

SUPERFÍCIES E ARQUITECTURA



SUPERFÍCIES E ARQUITECTURA



European Housing Expo 2001

SUPERFÍCIES E ARQUITECTURA



**Santiago Calatrava's 80 South Street
Nova York**

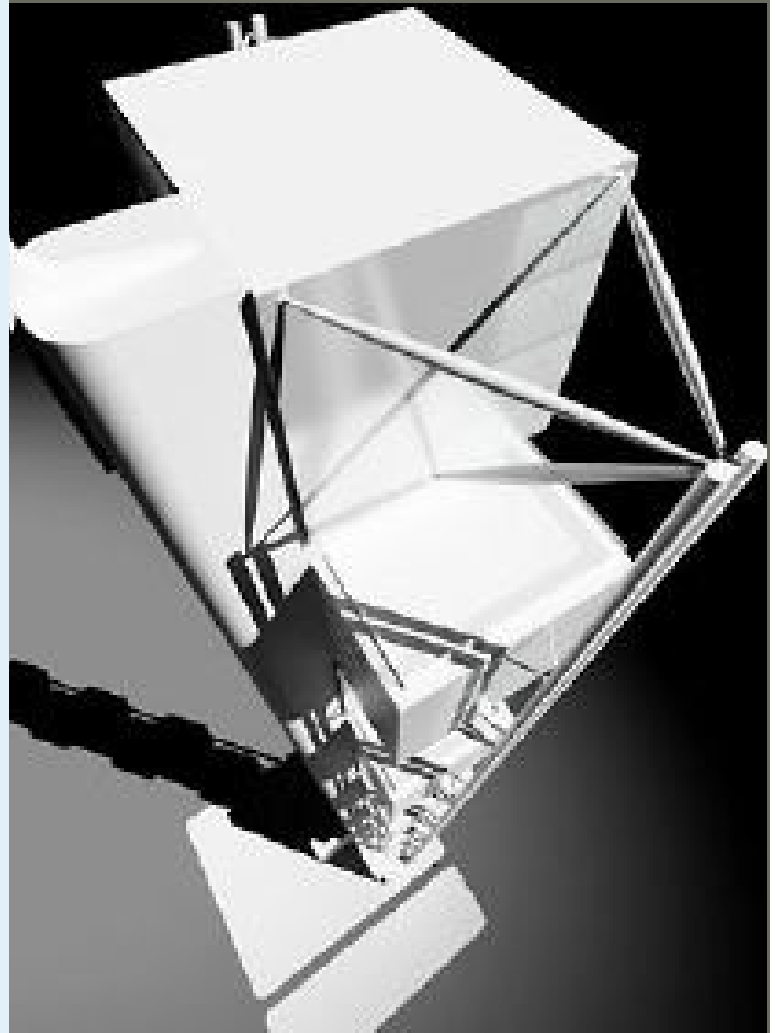

SUPERFÍCIES E ARQUITECTURA



Cidade das Artes e Ciências - Valência

SUPERFÍCIES E ARQUITECTURA



LIBRARY & LEARNING CENTER-UNIVERSITY OF ECONOMICS VIENNA , Vienna,
Austria, 2008-2012

SUPERFÍCIES E ARQUITECTURA

Santiago Calatrava, Fordham Spire, Chicago, Illinois, USA



SUPERFÍCIES E ARQUITECTURA



Expansion
Arquitectonica
Bronx Museum
of the Arts
Bronx, New
York

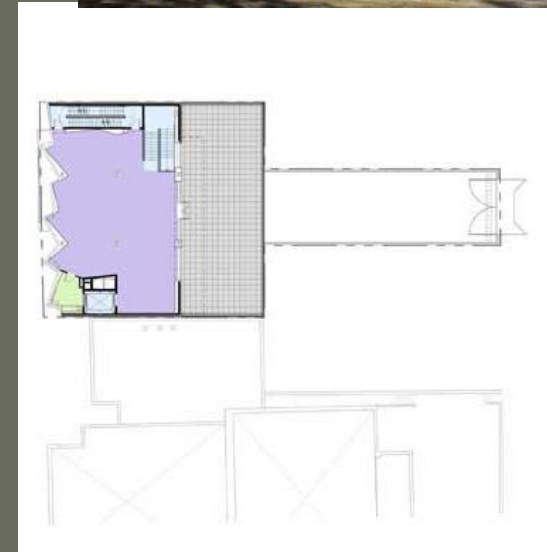
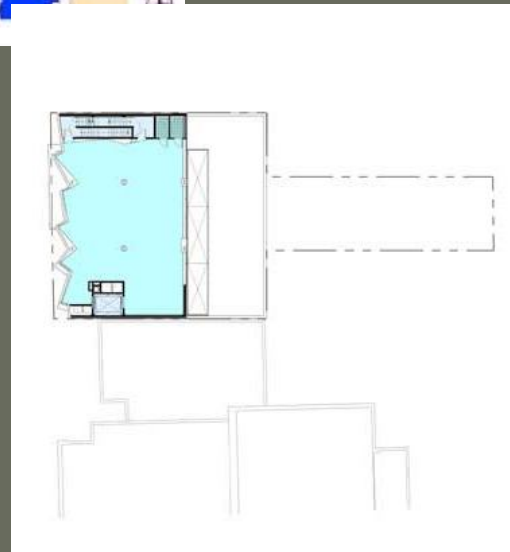

SUPERFÍCIES E ARQUITECTURA



Completed: October 2006

SUPERFÍCIES E ARQUITECTURA

Spacelab Cook-Fournier, Kunsthaus Graz, Graz, Austria, 2004



SUPERFÍCIES E ARQUITECTURA

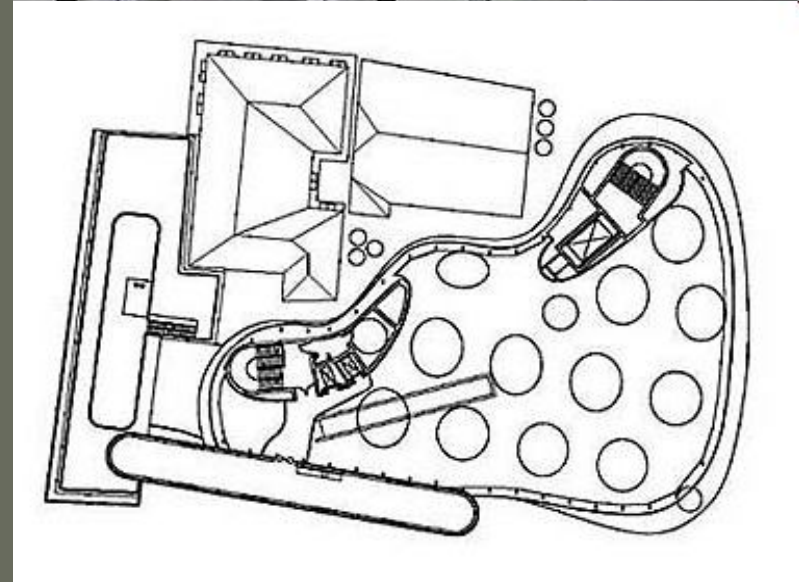
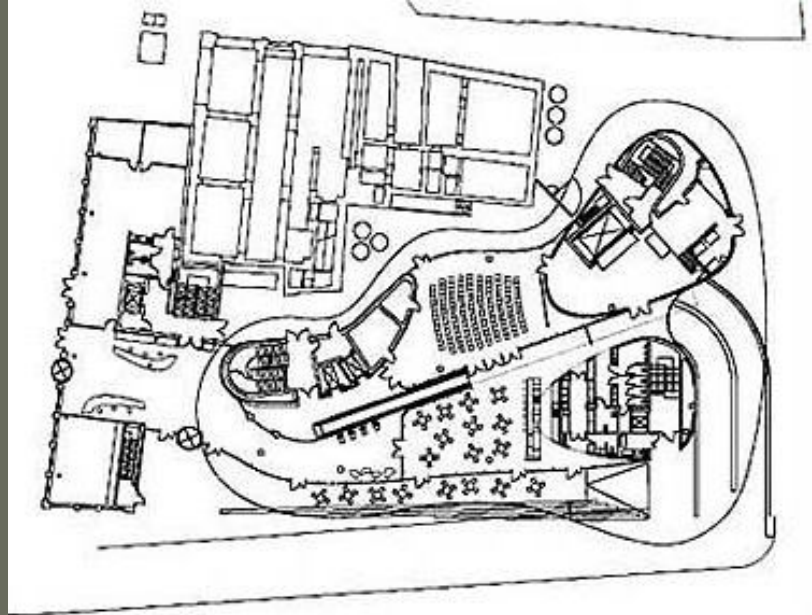

SUPERFÍCIES E ARQUITECTURA

LAB architecture studio, Guardian Towers, Danet Abu Dhabi,
Abu Dhabi, UAE - 2007



SUPERFÍCIES E ARQUITECTURA

Lab architecture studio, Soho Shang Du, Beijing, China

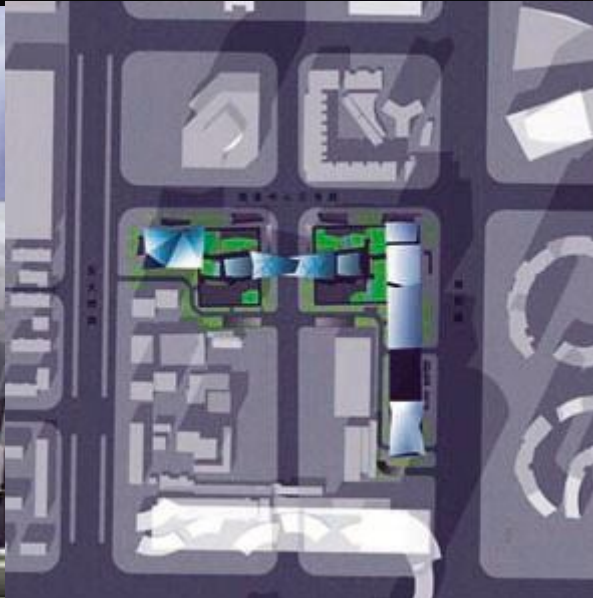

SUPERFÍCIES E ARQUITECTURA

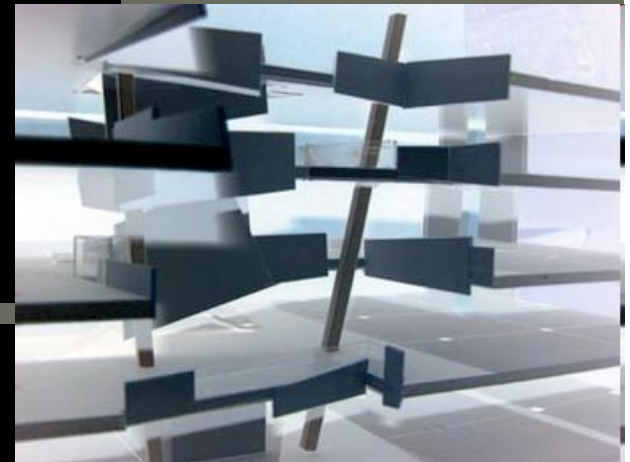
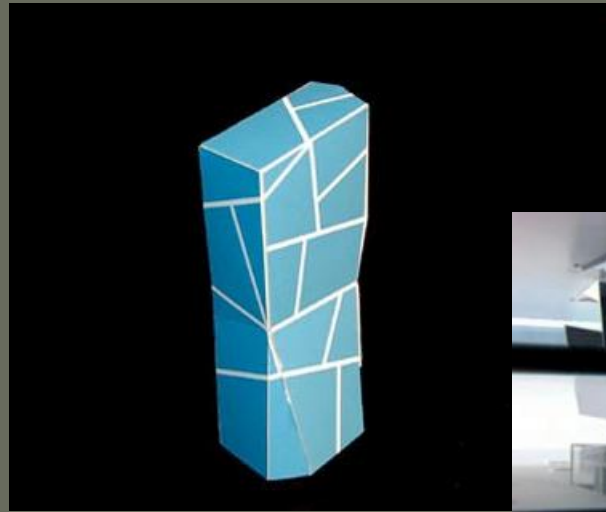
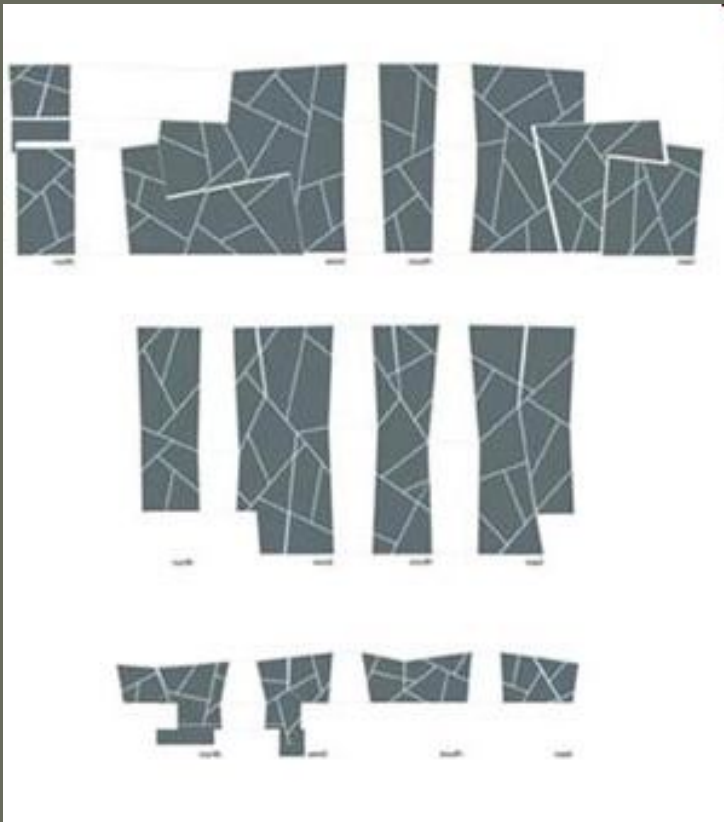

SUPERFÍCIES E ARQUITECTURA

Peter Zumthor, Brother Claus Field Chapel, Mechernich, Germany, 2007



SUPERFÍCIES E ARQUITECTURA

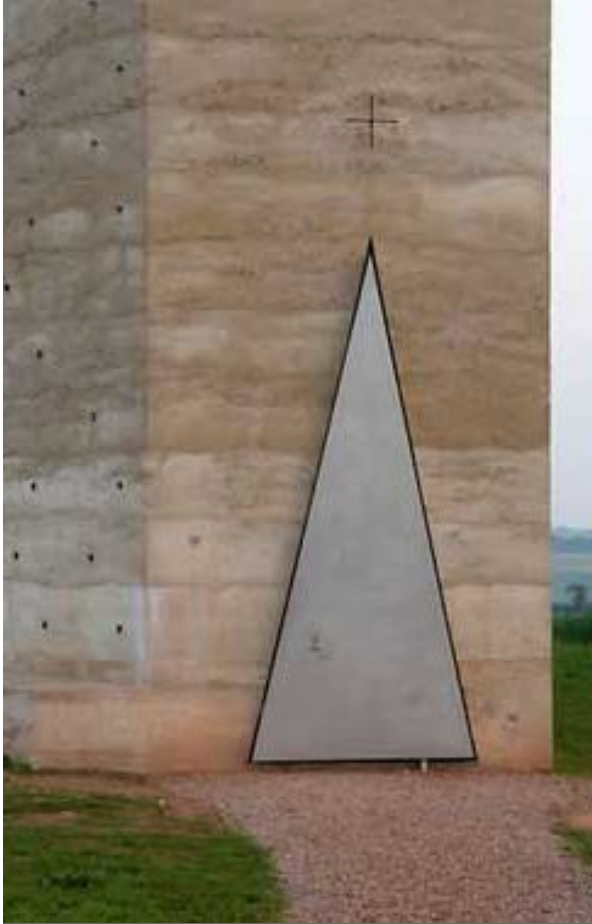

SUPERFÍCIES E ARQUITECTURA

Construction start, OMA, MahaNakhon, Bangkok, Thailand,
Rem Koolhaas OMA

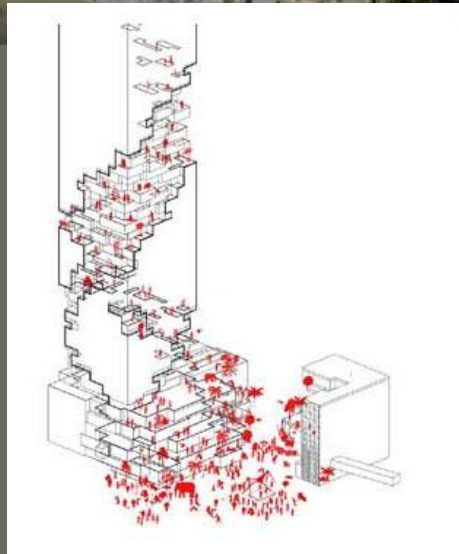

SUPERFÍCIES E ARQUITECTURA

Álvaro Siza , Meteorology Center, Barcelona, Spain

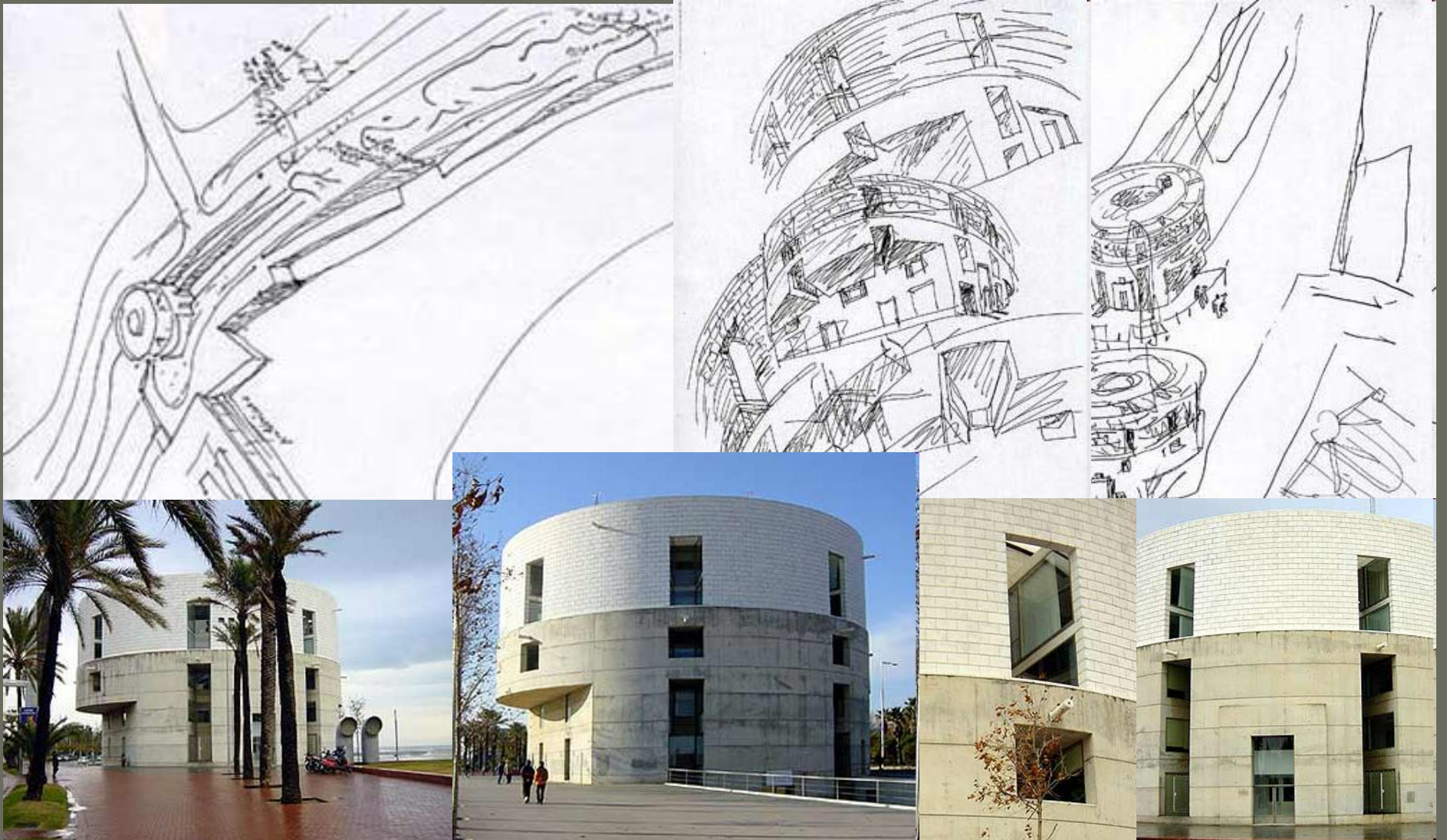

SUPERFÍCIES E ARQUITECTURA

Massimiliano Fuksas Architetto, Zenith Music Hall, Strasbourg, France



SUPERFÍCIES E ARQUITECTURA

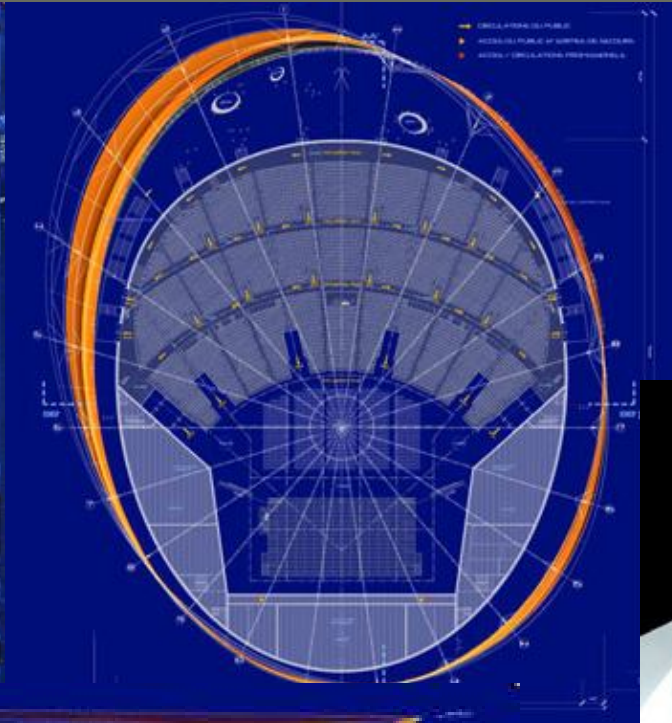
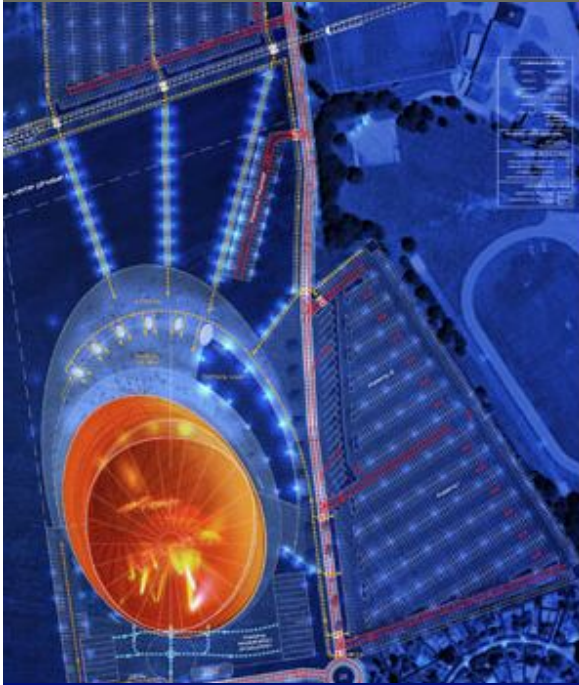

SUPERFÍCIES E ARQUITECTURA

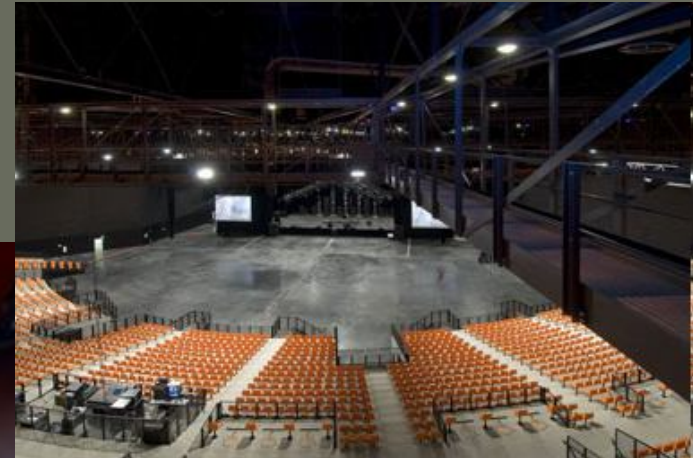

SUPERFÍCIES E ARQUITECTURA

BIG, National Library, Astana, Kazakhstan



SUPERFÍCIES E ARQUITECTURA

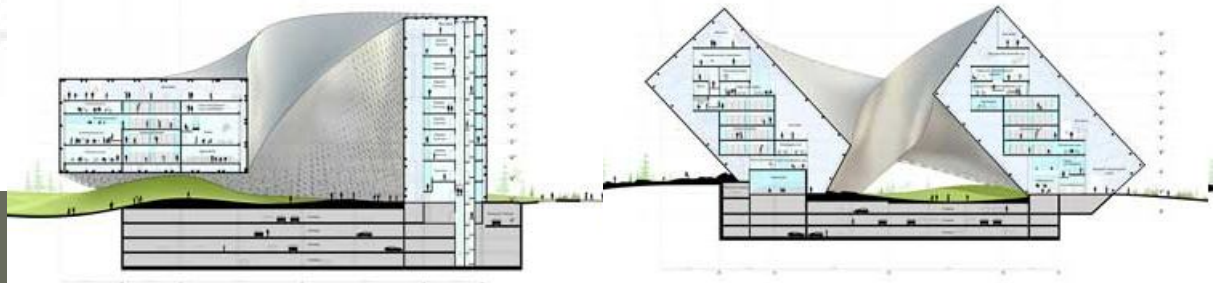
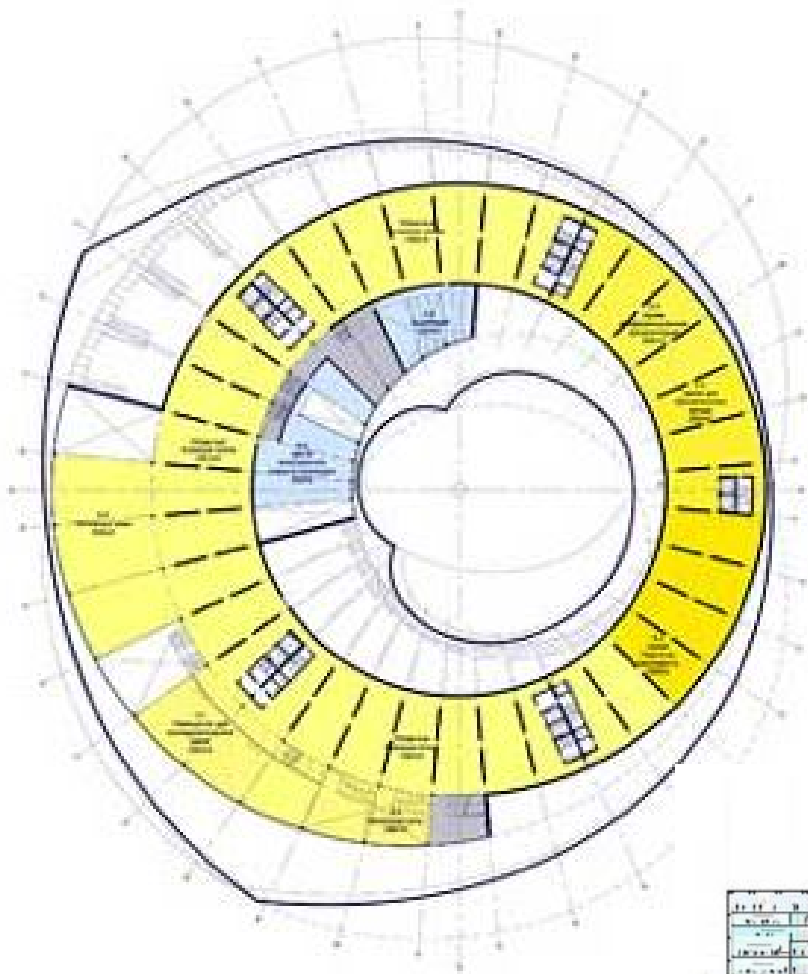

SUPERFÍCIES E ARQUITECTURA

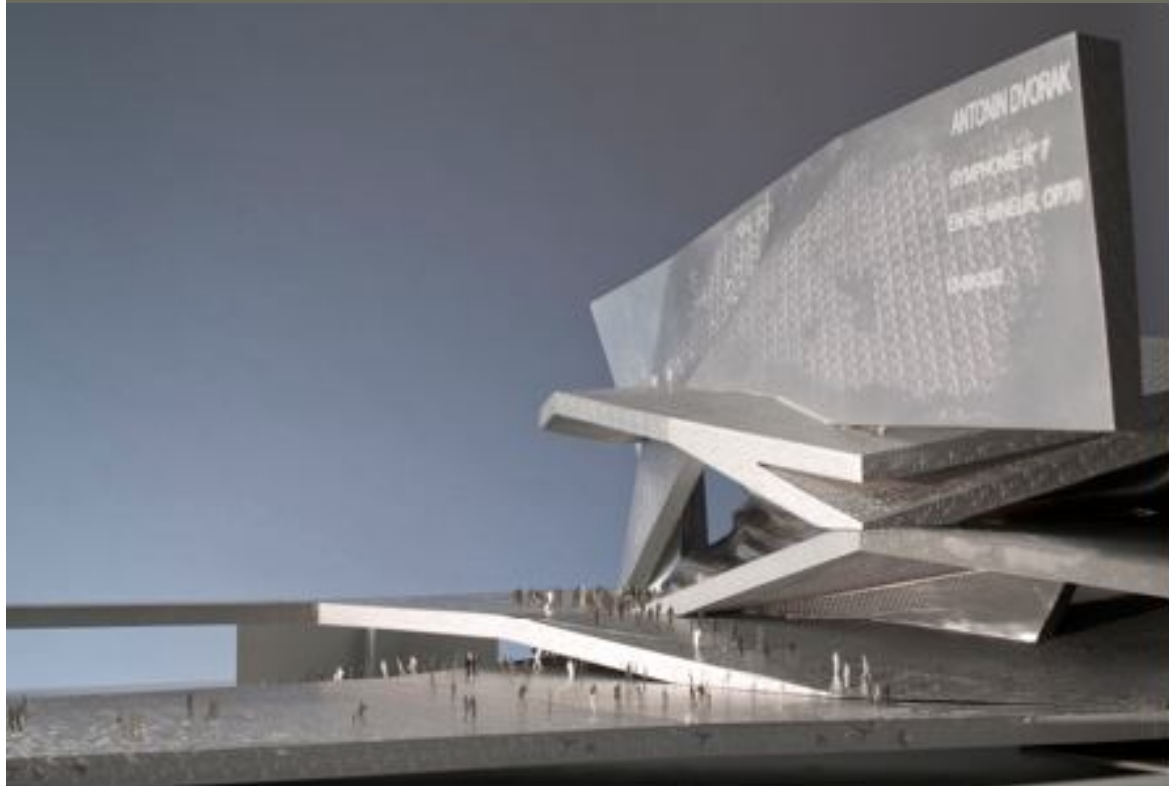

Jean Nouvel

La Philharmonie de Paris

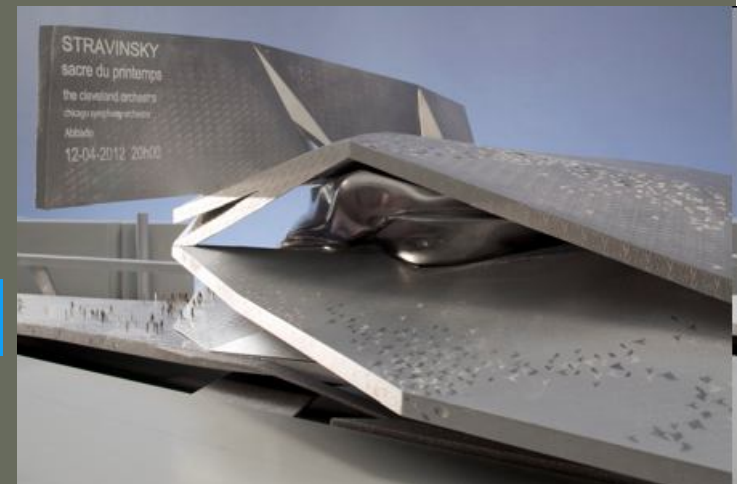

SUPERFÍCIES E ARQUITECTURA



Z15 Tower , Pequim - TFP Farrells, BIAD, ARUP and MVA Farrell TFP, ARUP, Biad e MVA

SUPERFÍCIES E ARQUITECTURA



Chaoyangmen Soho é a arquitetura contemporânea na China, um novo projeto de Zaha Hadid Architects



SUPERFÍCIES E ARQUITECTURA



Dubai: A cidade futurista

SUPERFÍCIES E ARQUITECTURA



SUPERFÍCIES E ARQUITECTURA



127 andares, 400 metros, Anara Tower, Arquitetura, Dubai, Michele D' Ippolito,
restaurante dentro dessa turbina Atkins Architects

Anara Tower

SUPERFÍCIES E ARQUITECTURA

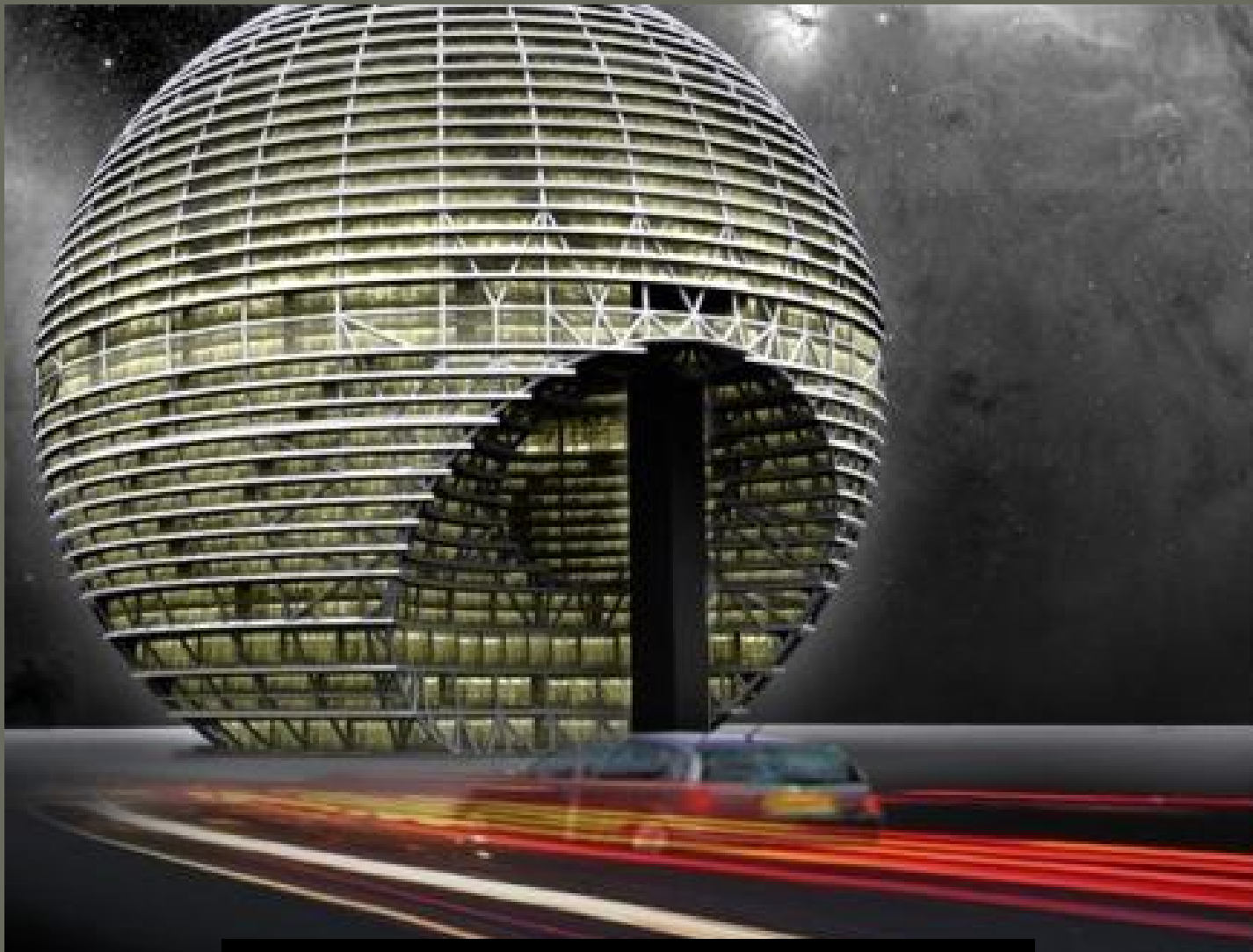

Rem Koolhaas OMA, Deathstar

SUPERFÍCIES E ARQUITECTURA

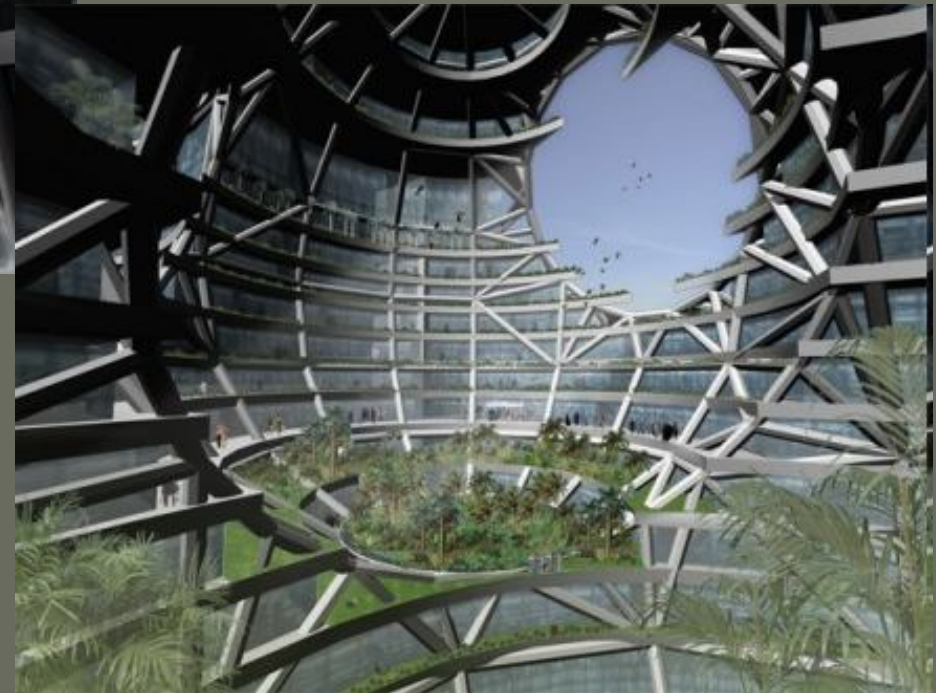

SUPERFÍCIES E ARQUITECTURA



Zaha Hadid, Dancing Towers

SUPERFÍCIES E ARQUITECTURA



Jean Nouvel, Dubai Opera House

SUPERFÍCIES E ARQUITECTURA



Trump International Hotel and Tower - Atkins Architects

SUPERFÍCIES E ARQUITECTURA



Joachim Hauser, Hydropolis Underwater Hotel

SUPERFÍCIES E ARQUITECTURA



Dubai terá não apenas a maior torre, mas também o maior centro comercial do mundo

SUPERFÍCIES E ARQUITECTURA



Uma bola de golfe inspirou Jon Jerde na obra deste centro comercial de Taipei

SUPERFÍCIES E ARQUITECTURA



Dubai Oman

SUPERFÍCIES E ARQUITECTURA



Desconstruído – Em tempo de pós-tudo, talvez um bom exemplo final seja o complexo The Ray and Maria Stata Center for Computer, Information and Intelligence Services, do famoso Instituto de Tecnologia de Massachussets, situado em Cambridge, nos EUA. Entregue em fins de 2004, consiste numa série de pequenos prédios, curvados e inclinados em ângulos bem artificiais. Custou US\$ 300 milhões e foi projetado por Frank Gehry, com apoio das firmas Cannon Design, Gail Sullivan Associates e dos arquitetos paisagistas da Olin Partnership.

SUPERFÍCIES E ARQUITECTURA



SUPERFÍCIES E ARQUITECTURA



A Mobile Chinatown - Superstar - MAD

SUPERFÍCIES E ARQUITECTURA



SUPERFÍCIES E ARQUITECTURA



Dubai Opera House

SUPERFÍCIES E ARQUITECTURA



Za'abeel Park Observation Tower By XTEN Architecture

SUPERFÍCIES E ARQUITECTURA



SUPERFÍCIES E ARQUITECTURA



Arquitecto italiano David Fisher

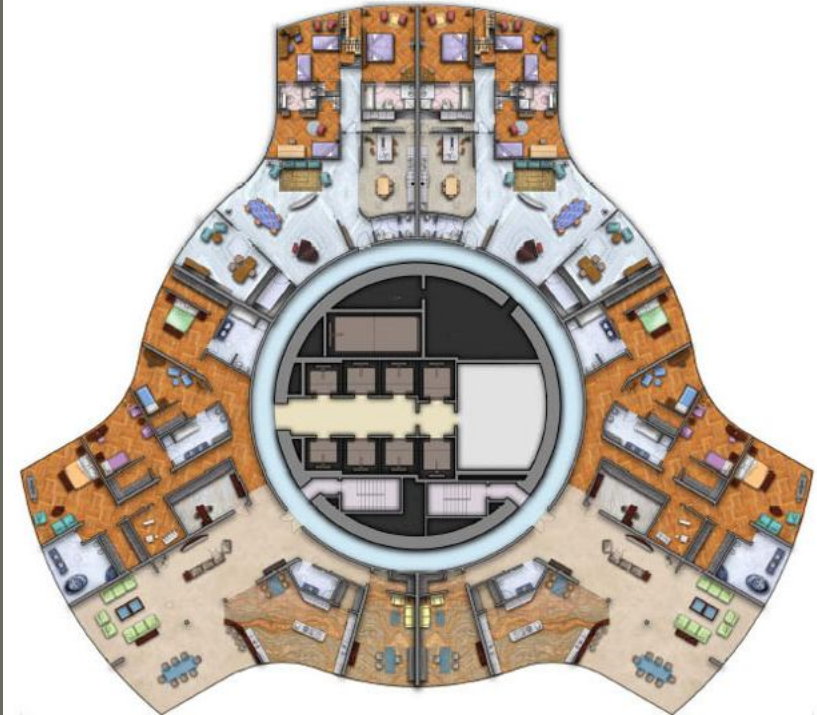

SUPERFÍCIES E ARQUITECTURA

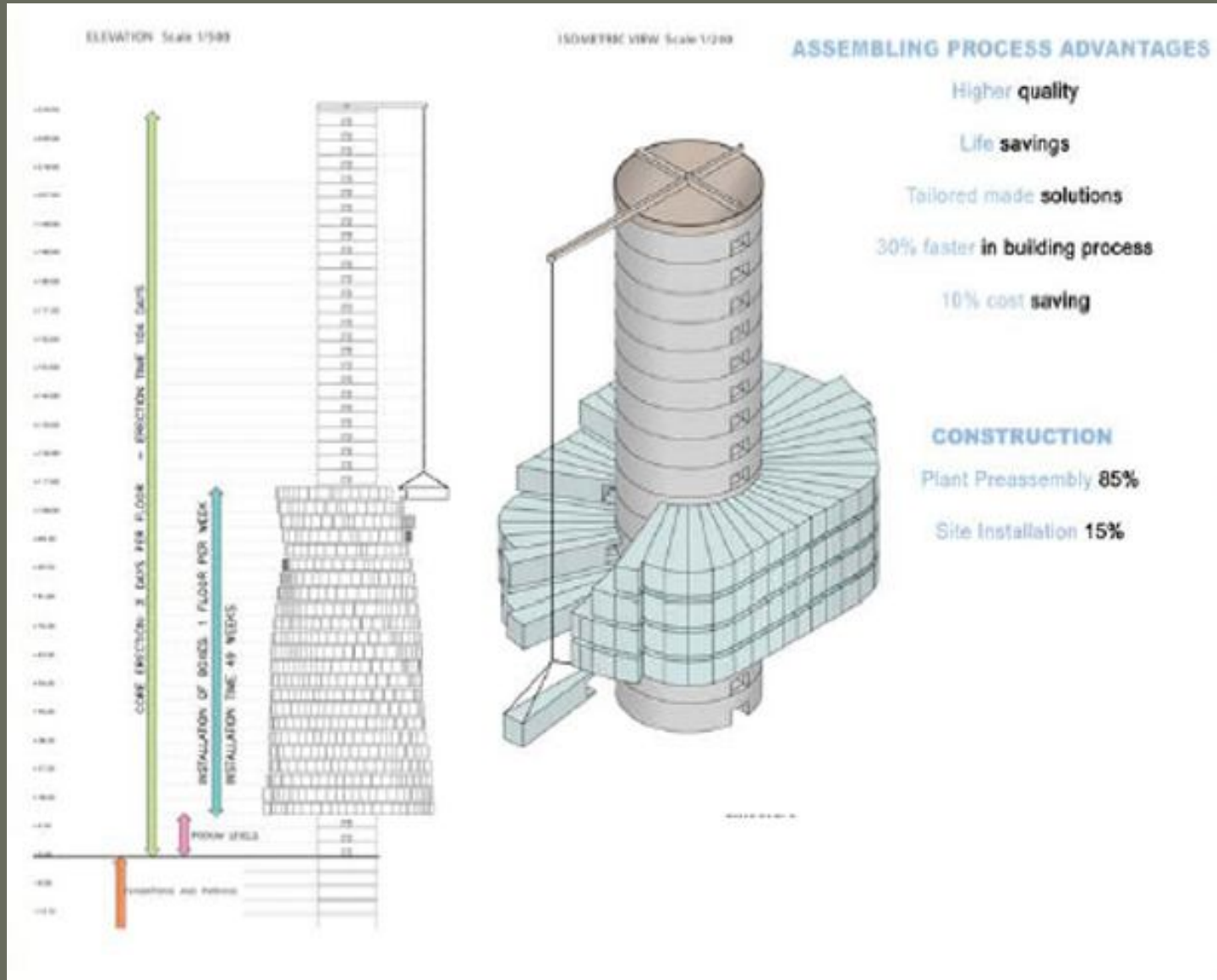

SUPERFÍCIES E ARQUITECTURA

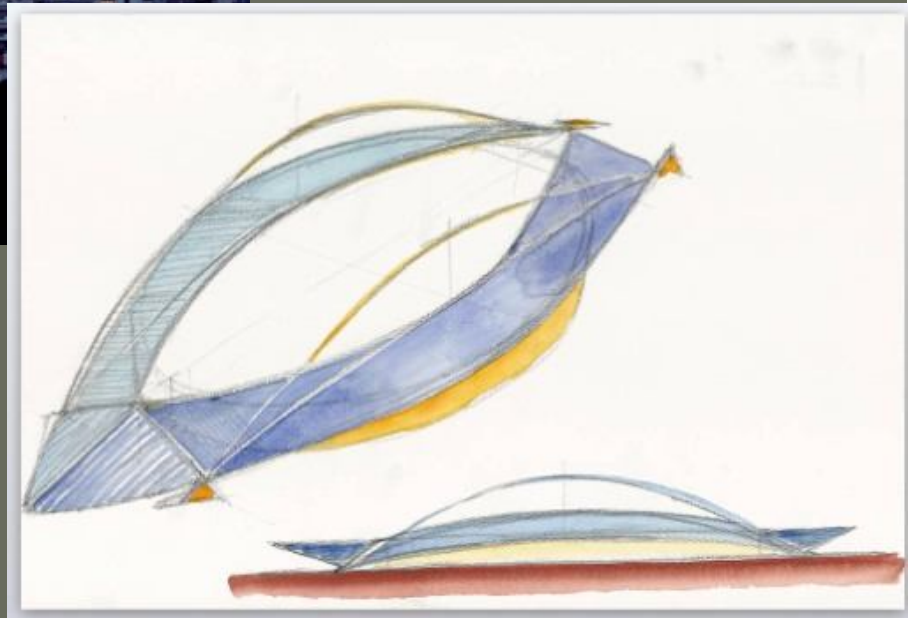

SUPERFÍCIES E ARQUITECTURA



SUPERFÍCIES E ARQUITECTURA

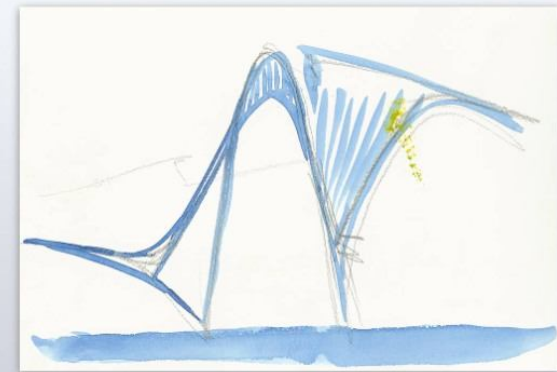

SUPERFÍCIES E ARQUITECTURA

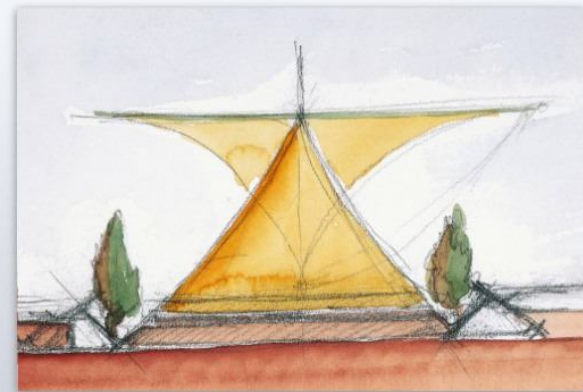

SUPERFÍCIES E ARQUITECTURA

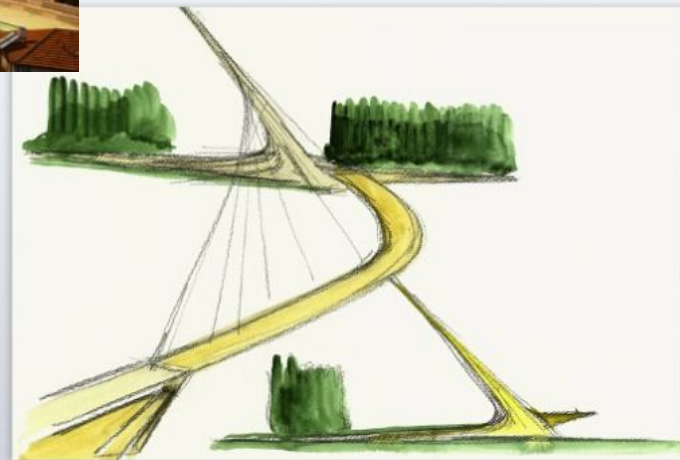

SUPERFÍCIES E ARQUITECTURA

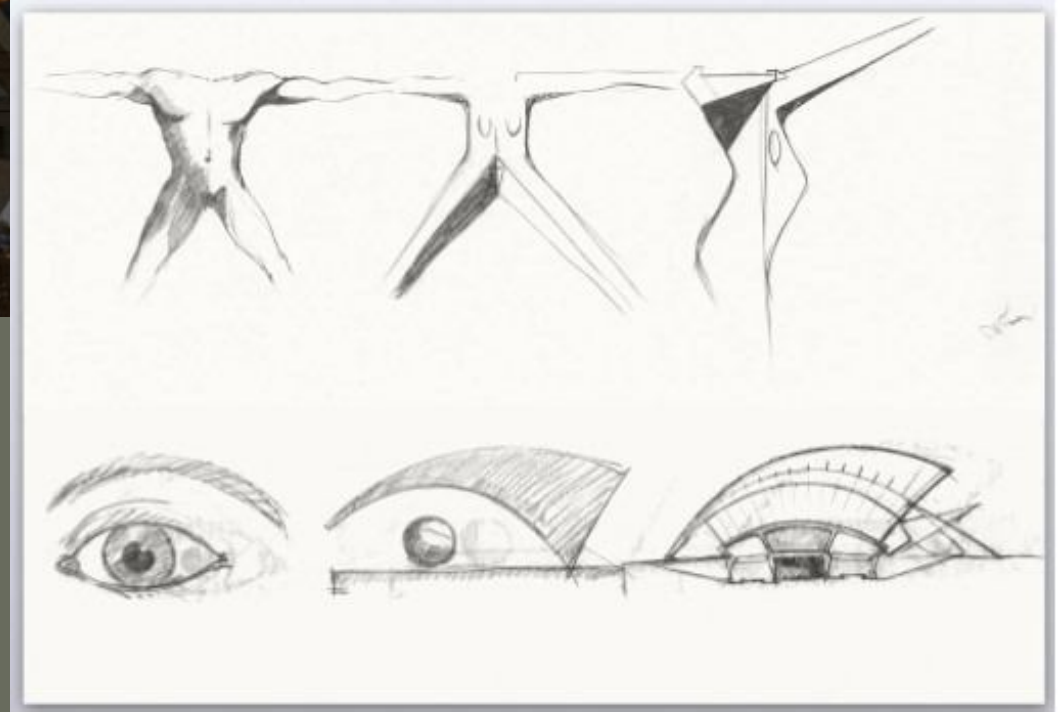

SUPERFÍCIES E ARQUITECTURA

<http://i245.photobucket.com/albums/gg64/z0rgggg/sg-36G.jpg>

<http://es.urbarama.com/project/schumacher-tower>

<http://www.calatrava.com/#/Selected%20works/Architecture?mode=english>

<http://www.chewing.com.br/blog/?p=920>

<http://abduzeedo.com.br/inusitada-da-arquitetura-de-dubai-parte-1>

http://www.youtube.com/watch?v=a_zbpiWr8_w&feature=related

<http://www.novomilenio.inf.br/real/ed144z.htm>

<http://paulooliveira.wordpress.com/2008/10/24/arquitetura-em-dubai/>

<http://www.piniweb.com.br/construcao/arquitetura/dubai-tera-predio-giratorio-de-80-andares-93971-1.asp>

<http://www.gizmodo.com.br/conteudo/panoramica-gigante-de-dubai-mostra-arquitetura-local>

<http://vanguarq.wordpress.com/tag/actualidad/>

<http://www.google.pt/images?hl=ptpt&source=hp&biw=1186&bih=493&q=arquitetura+do+dubai&gbv=2&aq=f&aqi=&aql=&oq=>

SUPERFÍCIES E ARQUITECTURA