

A COMPETITION ON ARCHITECTURE AND LANDSCAPE DESIGN: THE CONSTRUCTION OF A COMMON RESEARCH



II INTERNATIONAL WORKSHOP IN ALQUEVA | DESIGNING HERITAGE TOURISM LANDSCAPES



SITE VISIT

WORKPLACE



CONCEPT SKETCH

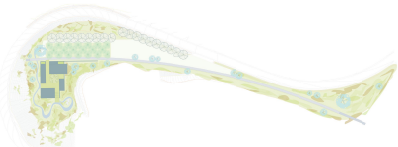

FIRST COMPUTER DRAWING

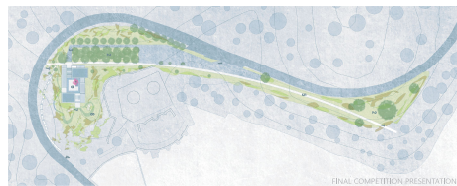

FINAL COMPETITION PRESENTATION

METHODOLOGY AND RESEARCH

Following an opportunity for a design competition including both Architecture and Landscape design, in a site that had been already studied by teachers and students in an international summer workshop, a new original joint proposal for the competition was drafted.

Throughout the whole design project the interdisciplinary experiences were articulated - firstly addressed in the pedagogical field with the international workshop and then in the professional context.

The disciplinary integration included a real project work, the adaptation of concepts and terminologies, the adjustment of types of discourses and arguments and methodological and instrumental cooperation.

The Interdisciplinary design process identified 4 characteristics of integrated and overlapping action:

- Integrative design (integrating architecture, engineer and landscape, connectivity, network, indoor-outdoor, borderless);
- Dynamic and evolutionary design (workshop and competition, importance of time and space: design for time and space, in time and space, with time and space);
- Generative and regenerative design (conservation, morpho ecology, repairing, recycling);
- Strategic design (system approach, ecological infrastructure, open design, sense and identity of place, embodied experience).

The possibilities of a vivid research dialog, negotiation and joint enrichment induced the project as a research event "on", "about" and "in" architecture and landscape design. The competition provided the need for innovation, inducing a mutual solution to a problem by the transdisciplinary artistic research, born amidst different researchers and teachers that contribute with their visions and abilities to a common idea for a project.

The competition, the project, the method is of service to each individual researcher and collectively to the project, and gives visible proof of the need of collaborative or cooperative learning and of competition as tactics for compelling research.

DRAWING THE SPACE

In Alqueva, Mira Lagos is a unique place, distinguished by the exceptional position in the territory, great visual domain on the great Lake, the dam, the Guadiana and the surrounding landscape. The uniqueness of the site also stems from the almost dramatic artificialization it presents between the landscape and the scale of the infrastructure associated with the dam.

During the construction of the dam and the supporting infrastructure, it was necessary to cut, excavate and tear the slope / hill, (re) designing this place, of Mira Lagos, with new platforms, depressions and great unnatural vertical planes. This transformation process altered the topography, destroyed the vegetation cover, creating not only a significant negative impact on that landscape, but also leaving a legacy of inert structures resulting from the work phase of this infrastructure, in particular a large paved shaft with a longitudinal lane and the set of large blocks in reinforced concrete.

Recognizing the intrinsic, privileged and strategic value of this place, for the location of the Alqueva Dam Observation and Command Center and Interpretive Center (POCCI), the project strategy proposes to (re) build this place. The project is thus an opportunity not only to install the POCCI, but also to (re) build a destroyed and degraded territory, to rebuild the hill and to promote the protection and valorization of areas that have a high ecological sensitivity.

The project extends to the territory of Mira Lagos (with access by the N255 road) and is conceived as an integral part of the POCCI. In this environment it is planned to redesign the hill to cover with the vegetable cover identity of this landscape and, also, to create places of recreation, of stay and viewpoint. The paths (direct or wandering) and vegetation (visible expression of the ecology of the place) become, therefore, structuring elements of the project.

1 terrace / greenwood forest | 2 pre-existing industrial site | 3 stair path | 4 POCCI patio / courtyard | 5 interpretative center | 7 outdoor | 8 auditorium
9 panoramic platform | 10 main access | 11 water mirror | 12 perspective | 13 wall | 14 technical platform | 15 stairs panoramic platform | 16 kitchen | 17 technical base outside

